

AGRICULTURAL MACHINERY

sitrex®
s.r.l.

**ASSEMBLY, USE AND MAINTENANCE
SPARE PARTS LIST**

ST/384-H ST/520-H

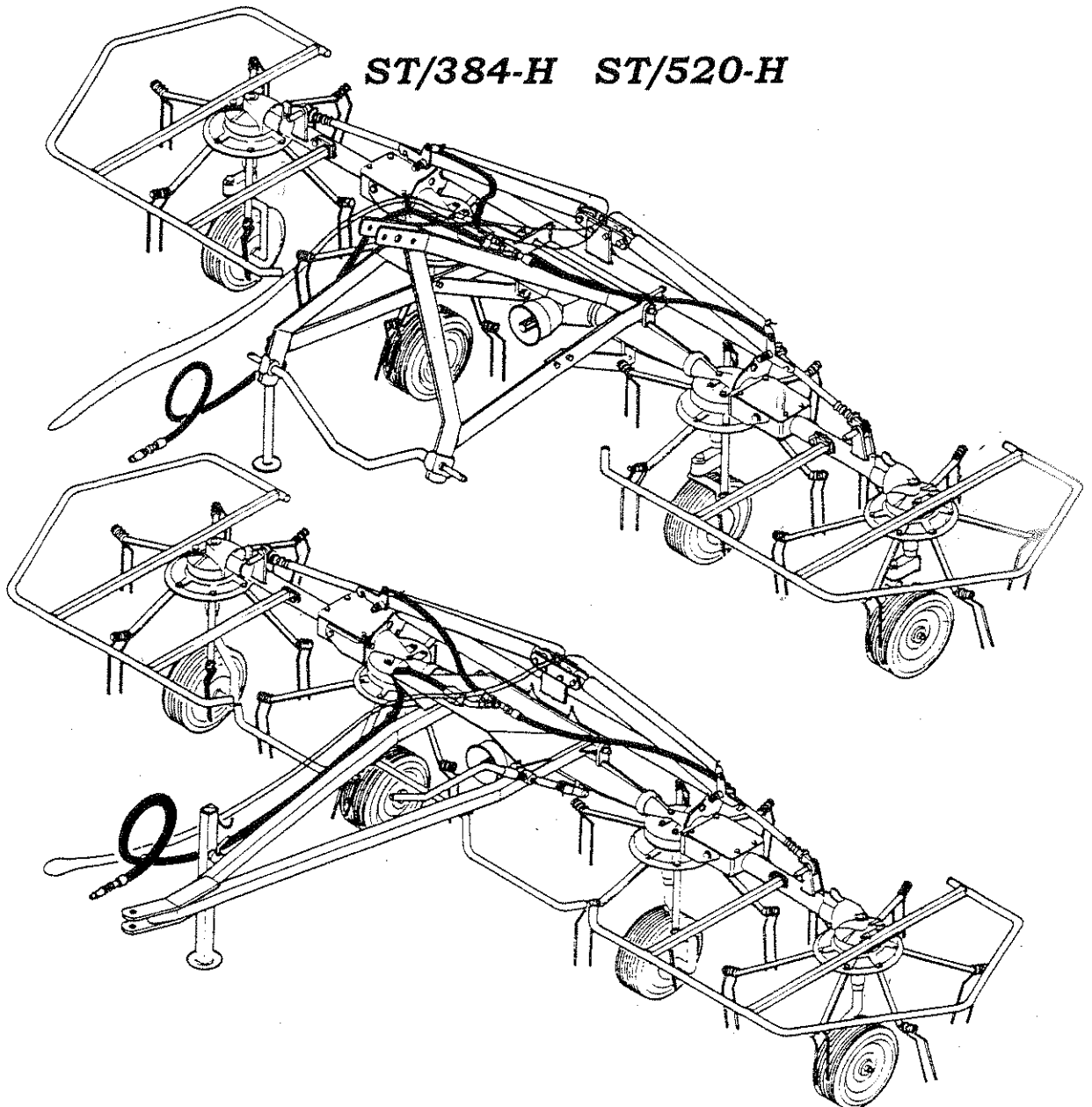

ROTARY TEDDER

WARRANTY

SITREX s.r.l. warrants new SITREX machinery at the time of delivery to the original purchaser to be free from defects in material and workmanship if properly set up and operated in accordance with this Operator's Manual.

SITREX undertakes to repair or replace free of charge any defective part which should be returned by the purchaser (freight prepaid) and found to be defective by inspection authorized by SITREX during the warranty period.

This warranty will be valid for 12 (twelve) months from the delivery of goods to the original purchaser .

In case the customer is not in a position to return the defective part to the manufacturer , the manufacturer cannot be held responsible for any cost due for repair or replacement of any part of the machine , he will only supply the part(s) required for the repair and/or replacement.

The warranty is null and void when it is evident that the machine has been improperly used or however repaired without authorization.

SITREX undertakes no responsibility for any obligation or agreement reached by any SITREX employers, agents or dealers, which are not in compliance with the above warranty . The manufacturer cannot be held responsible for the consequent damages. This warranty substitutes any other warranty , express or implied , and any other manufacturer's obligation.

**GUIDE TO THE SIGNS AND SYMBOLS USED THIS MANUAL AND
THEIR LOCATION ON THE MACHINE**

IMPORTANT

These signs and symbols give information to the operator on how to make the best use of the machine so as to prolong life, avoid damage, optimise work and, above all, to avoid injury to the operator and anyone within range of the machine.

WARNING SIGNS

1

Before beginning operations, read the instruction manual carefully.

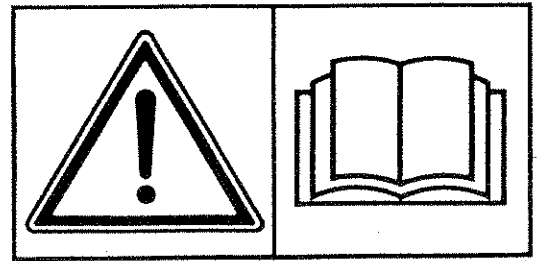

2

Before undertaking any maintenance, stop the machine and support it on the ground. Then consult the instruction manual.

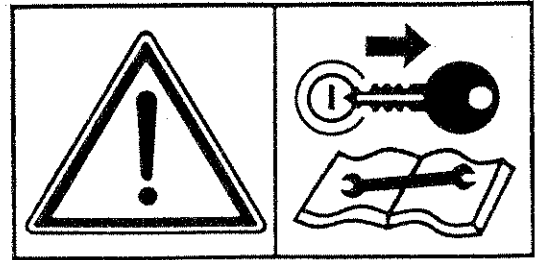

3

This is a warning to use proper accident protection when carrying out maintenance and repairs

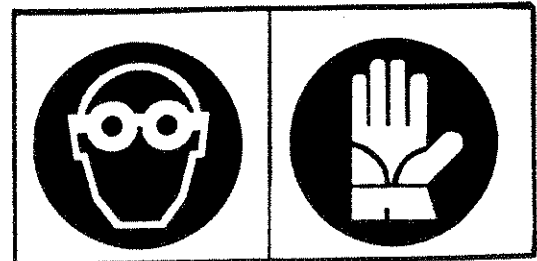

DANGER SIGNS

4

Risk of possible ejection of blunt objects. Keep a safe distance from the machine.

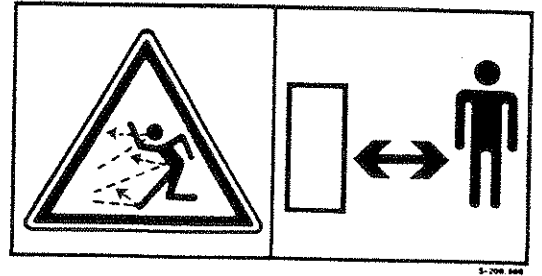

5

Indicates that anyone coming within range of the moving tine arms will be seriously injured. Keep a safe distance from the machine.

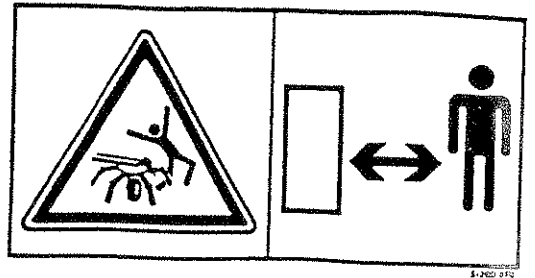

6

Indicates that there is a risk of crushing your hands. Keep your distance.

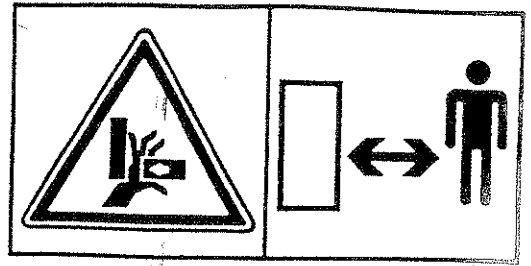

7

Indicates danger caused by accidental fall of suspended arms. Keep safe distance.

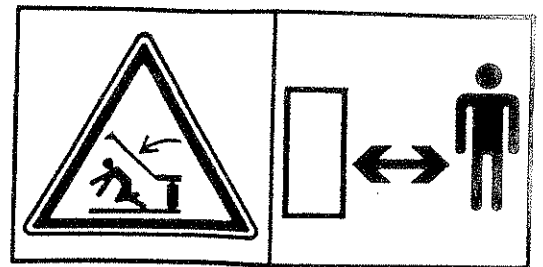

8

Indicates that it is dangerous to touch the Cardan (P.T.O.) shaft.

For all the other information regarding the Cardan (P.T.O.) shaft, see the use-and-maintenance booklet specifically for the Cardan (P.T.O.) shaft which, together with this manual, makes up the documentation on safety, use and maintenance of the machine.



INDICATION SIGNS

- 9 Indicates a greasing point.



- 10 Shows the direction of rotation of the power takeoff and the maximum number of revolutions.

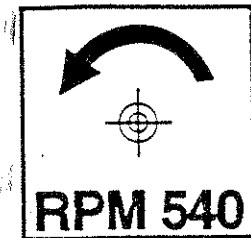

- 11 Indicates position of the tines on the rotors and their direction of rotation.

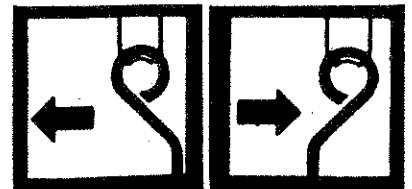

GENERAL SUMMARY OF SAFETY AND ACCIDENT PREVENTION INSTRUCTIONS

Read all the instructions carefully before using the machine. When in doubt seek advice from the manufacturing company.

The manufacturing company declines all responsibility for non-compliance with the following safety and accident prevention instructions.

1. Pay attention to the danger signs and symbols in this manual and on the machine.
2. Do not touch moving parts.
3. All work on the machine (including adjustments) must always be carried out with the tractor immobilised and the engine switched off.
4. On no account may persons or animals be carried on the machine.
5. Driving the tractor with the machine connected is absolutely forbidden to persons lacking suitable experience, or who are in poor health, or who are too young or do not have a suitable driving licence if travelling on the highway.
6. All accident prevention measures recommended in this manual should be scrupulously observed.
7. Connecting the machine to the tractor creates a different weight distribution on the tractor axles and so it is essential to ensure that the tractor-machine combination is stable in all anticipated working condition. It is therefore necessary to have exact instructions from the tractor manufacturers. If such instructions are not available, suitable tests should be conducted in safe conditions in order to assess stability.
8. Once the machine is connected it can only be controlled through a Cardan (P.T.O.) shaft complete with the required overload protection and guard secured with the appropriate small chains. Be aware of the rotational direction of the Cardan (P.T.O.) shaft.
9. Before operating the tractor and machine, check that all transport and operational safety devices are complete and working.
10. When driving on public roads, you should comply with the highway code regulations for the country concerned.
11. Do not exceed the tractor axle maximum weight and the total mobile weight.
12. Before starting work, familiarise yourself with the control devices and how they work.
13. Wear suitable clothes. Do not wear clothing which is loose or which could become entangled in rotating or moving parts.
14. Connect the machine to a suitably powerful tractor by using an appropriate lifting unit and in accordance with instructions.
15. Take maximum care when connecting and disconnecting the machine to and from the tractor.

16. The machine and any road transport attachments must bear the appropriate signs and symbols and have suitable protection.
17. Never leave the driving seat when the tractor is running.
18. It is extremely important to appreciate that road-holding, steering and braking may be significantly affected with the machine attached.
19. When turning corners with the machine attached, be aware of the fact that the centrifugal force will alter due to the change in the centre of gravity.
20. Before engaging the power takeoff, check the pre-set revolution speed, **MAXIMUM 540rpm.** Do not use 1000rpm drive.
21. Under no circumstances should anybody stand near the machine or any moving parts. It is the duty of the operator to ensure that this requirement is respected.
22. Before leaving the tractor, lower the machine with the lifting unit, stop the engine, apply the parking brake and remove the ignition key from the instrument panel.
23. Under no circumstances should anybody go between the tractor and the machine (Fig.1) when the engine is running and the Cardan (P.T.O.) shaft is engaged, especially without first having applied the parking brake and placed chocks against the wheels.
24. Before connecting or disconnecting the machine to or from the 3-point linkage, put the lifting unit lever into the locked position.
25. The connection pins on the machine must match the connection sockets on the lifting unit.
26. During transport, stop machine sway, secure the lower lift arms with the stabilisers or check chains.
27. When the machine is raised during road transport, put the tractor's hydraulic lift control lever into the locked position.
28. Only use the Cardan (P.T.O.) shaft provided by the manufacturer and, in case of replacement, substitute it with one having the same characteristics.
29. Regularly check all protection guards on the Cardan (P.T.O.) shaft. These should always be in excellent condition and securely fixed.
30. It is important to ensure that the protection on the Cardan (P.T.O.) shaft is complete.
31. Connection and disconnection of the Cardan (P.T.O.) shaft must be carried out with the engine stopped and switched off.
32. Pay particular attention to the correct connection and safety of the Cardan (P.T.O.) shaft and the power takeoffs on the machine and the tractor.

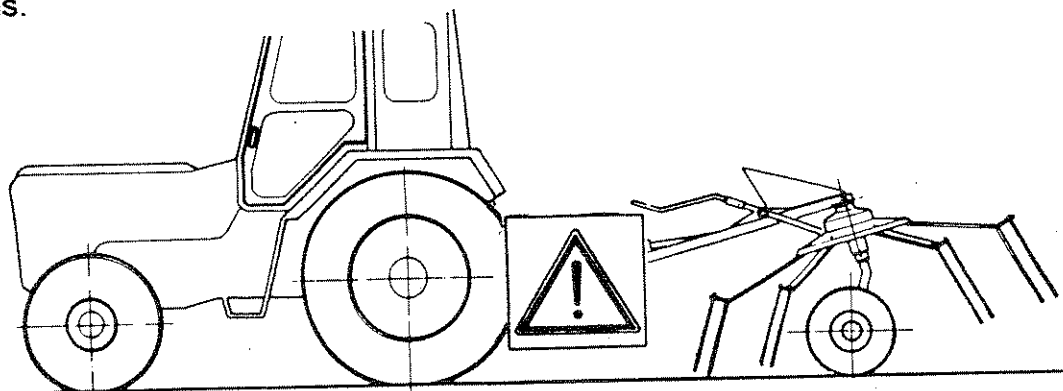

33. Prevent the Cardan (P.T.O.) shaft protection from rotating using the chains supplied.
34. Before engaging the power takeoff, make sure that there are no people or animals in the vicinity and that the selected engine speed corresponds to the Cardan (P.T.O.) speed permitted. 540rpm **MAXIMUM**.
35. Do not engage the power take-off when the engine is not running.
36. Always disengage the power take-off when the Cardan (P.T.O.) shaft is at too wide an angle (it should never be more than 35° - Fig.2) and when it is not in use.

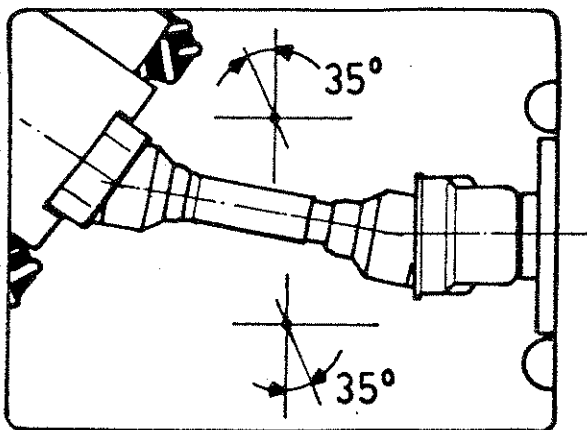

FIG. 2

37. Only clean and grease the Cardan (P.T.O.) shaft when the power takeoff is disengaged, the engine is off, the parking brake is applied and the ignition key is removed.
38. When the Cardan (P.T.O.) shaft is not in use, rest it on the support provided.
39. On disconnecting the Cardan (P.T.O.) shaft, replace the protective cover on the power input (gearbox) shaft.

40. Prolonged use of the machine can cause the drive boxes (Fig.4) to become hot. To avoid any risk of getting burnt, avoid touching these areas both during use and some time afterwards.
41. Periodically check screws and nuts for tightness and grip. Tighten as necessary.
42. When the machine is raised for maintenance work and tine replacement, put suitable supports under the machine as a safety precaution.
43. Ensure that the recommended grease is used.
44. Spare parts must meet the requirements as defined by the manufacturer. Use only original spare parts.
45. Safety decals must always be clearly visible. They must be kept clean and replaced if they become too illegible (they can be ordered from the dealer if necessary).
46. The instruction booklet must be available to all users for the lifetime of the machine.

PRODUCT IDENTIFICATION

MAIN COMPONENTS

- 1) 3-Point Hitch (carry-type machines)
- 2) Drawbar (pull-type machines)
- 3) Drawbar parking stand
- 4) Machine body
- 5) Lateral arms)
- 6) Protective guards
- 7) Tine bar assembly
- 8) Wheel assembly
- 9) Hydraulic kit
- 10) Cardan shaft
- 11) Identification plate

TECHNICAL DATA

| SPECIFICATIONS | ST/384-H | ST/520-H |
|-------------------------|------------|------------|
| Number of impeller | 4 | 4 |
| Arm for impeller | 4 | 6 |
| Working width mm/feet | 3820/12'6" | 5200/17'1" |
| Power required HP/KW | 15/11 | 22/16 |
| Weight KG/LBS | 295/650 | 410/900 |
| Transport width mm/feet | 2900/9'5" | 3050/10' |
| Operating speed Kmh/MPH | 16/10 | 16/10 |
| Tire size | 16x6.50-8 | |

All data are indicative. The SITREX company reserves the right to change them without advance notice.

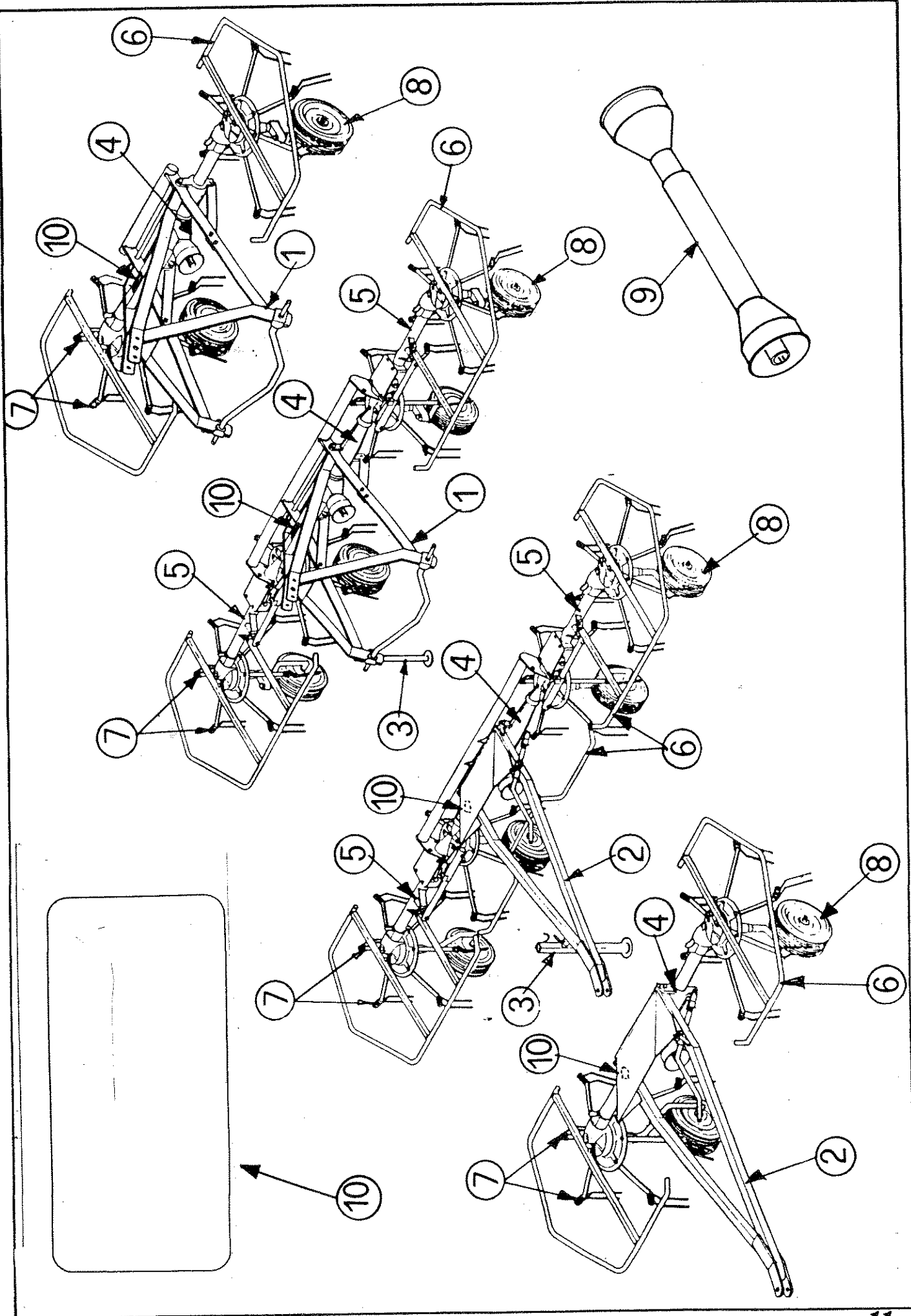

DELIVERY AND ASSEMBLING

Checking the machine on delivery

All parts are carefully checked before dispatch or delivery.

On receiving the machine, ensure that it has not been damaged during transport.

If damage has occurred, contact the dealer concerned.

How the machine is lifted will depend on the model and the type of packing.

Details are given below

The packing can vary from country depending on transport requirements.

UNPACKING THE MACHINE



DANGER III



Lift the machine using a forklift truck, crane or other suitable equipment of sufficient capacity after first checking the weight of the configurations in the table given below. Check the stability and positioning of the load on the forklift truck forks or crane hook. Keep the load as low as possible during movement for maximum stability and to ensure that the operator has maximum visibility. If a forklift truck is used, ensure that the forks are positioned as wide apart as possible.

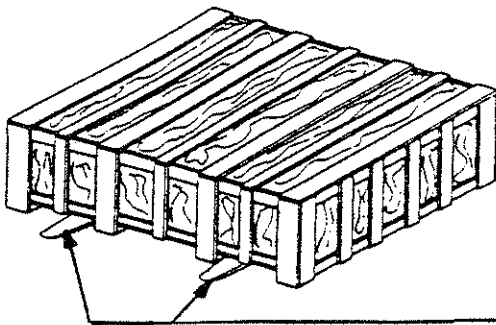

FORKLIFT LIFTING POINTS

| MACHINE | KG | WEIGHT | LBS |
|----------|-----|--------|-----|
| ST/384-H | 345 | | 760 |
| ST/520-H | 450 | | 990 |

Notes:

- 1) Machines are delivered in packaging suitable for shipping and handling. Nonetheless, it is recommended that care be used when handling.
- 2) For storage, it is possible to stack 2 - 3 crates on top of each other, making sure that they are stacked in perfect alignment.
- 3) For any further transport, make sure that the crates are secured firmly to the transport vehicle.
- 4) The packaging consists mainly of wood and nylon wrapping. These materials should be disposed of properly according to the laws in force in the country where the machine is delivered.

ASSEMBLY



DANGER !!!



Assembly is highly dangerous and must be carried out in strict accordance with the following instructions. We recommend that assembly be performed by qualified personnel. We also recommend that assembly be carried out in a flat, open area with no people (particularly children) nearby who could be severely injured if they were to touch or move any parts of the machine.

ASSEMBLY OF WHEEL SUPPORTS

PULL-TYPE MACHINES

- 1) To facilitate the assembly of the wheel supports, we advise that you turn the machine body upside-down. If you choose to use a different assembly method, bear in mind that once pins 5 and bushings 6 (pre-assembled by us in the shop to guarantee correct assembly and safe handling of the machine) are removed, the rotor assemblies 1-2-3-4 are free to move from their mounting, causing problems both for correct assembly and for the safety of the operators. **USE MAXIMUM CAUTION.**
- 2) Remove pins 5 and bushings 6 (keep in mind the warnings in step 1).
- 3) To avoid errors in assembly, we have numbered both the wheel supports 1-2-3-4 and the rotor assemblies 1-2-3-4 with stickers. Therefore, one needs simply combine the wheel support marked "1", with the relative rotor marked "1", and so on.
- 4) Before moving on to the fastening of wheel supports 1-2-3-4 to the respective rotors, make sure that the position of holes A-B-C-D of the rotor disks are positioned as shown in Fig. B.
- 5) Now fasten wheel supports 1-2-3-4 using spring pins 5-7.

ST/384-ST/520 PULL TYPE

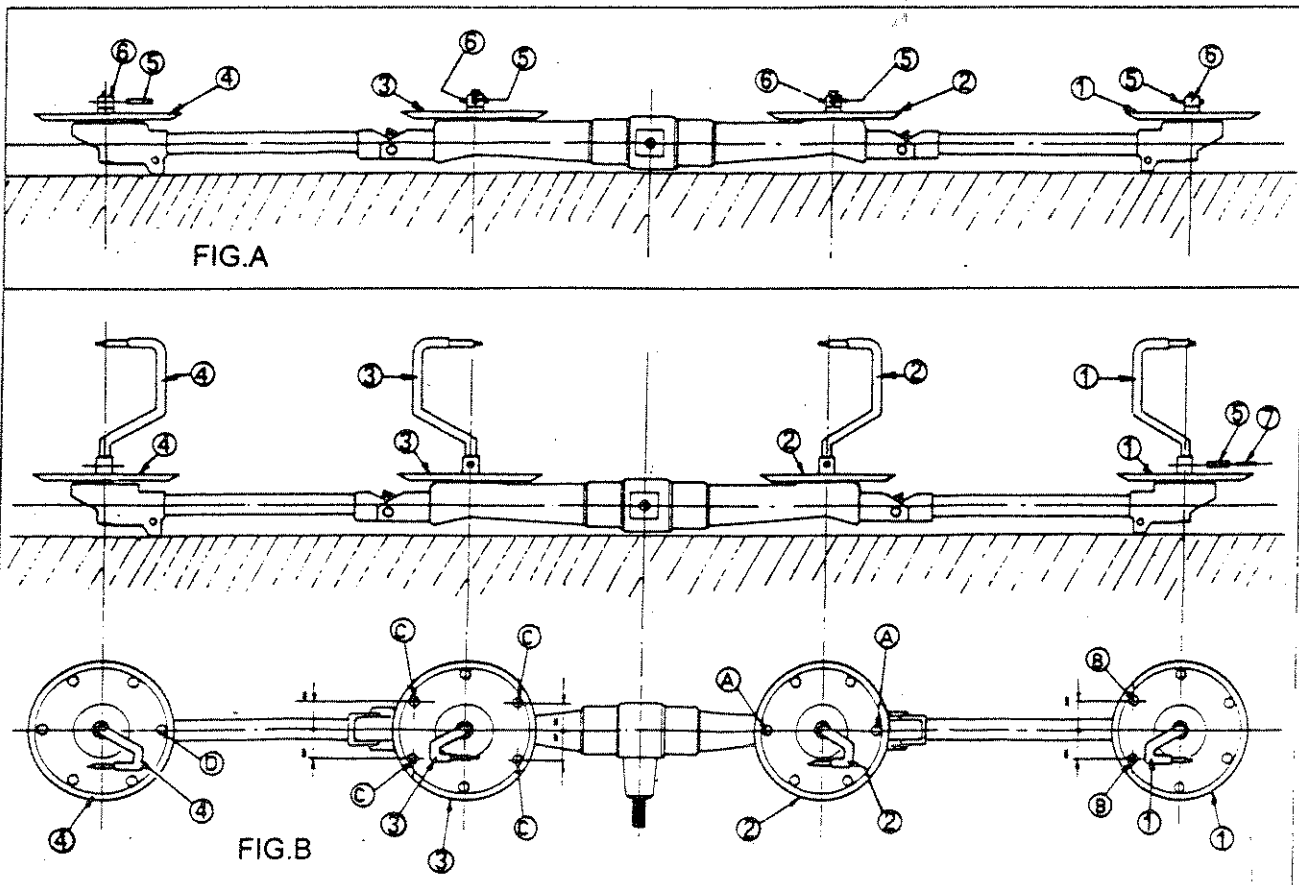

3-POINT HITCH-TYPE MACHINES

- 1) To attach the wheel supports for this type of machine it is not necessary to turn it upside-down. However, it is best to raise it with a suitable hoist.
- 2) After having lifted the machine, attach wheel supports 1 - 2 to the respective rotors (see Fig. C), placing spacers 3 - 4 in between, and fasten all with pin 5.
- 3) Attach grease nipples 6 to the proper holes as shown in Fig. C.

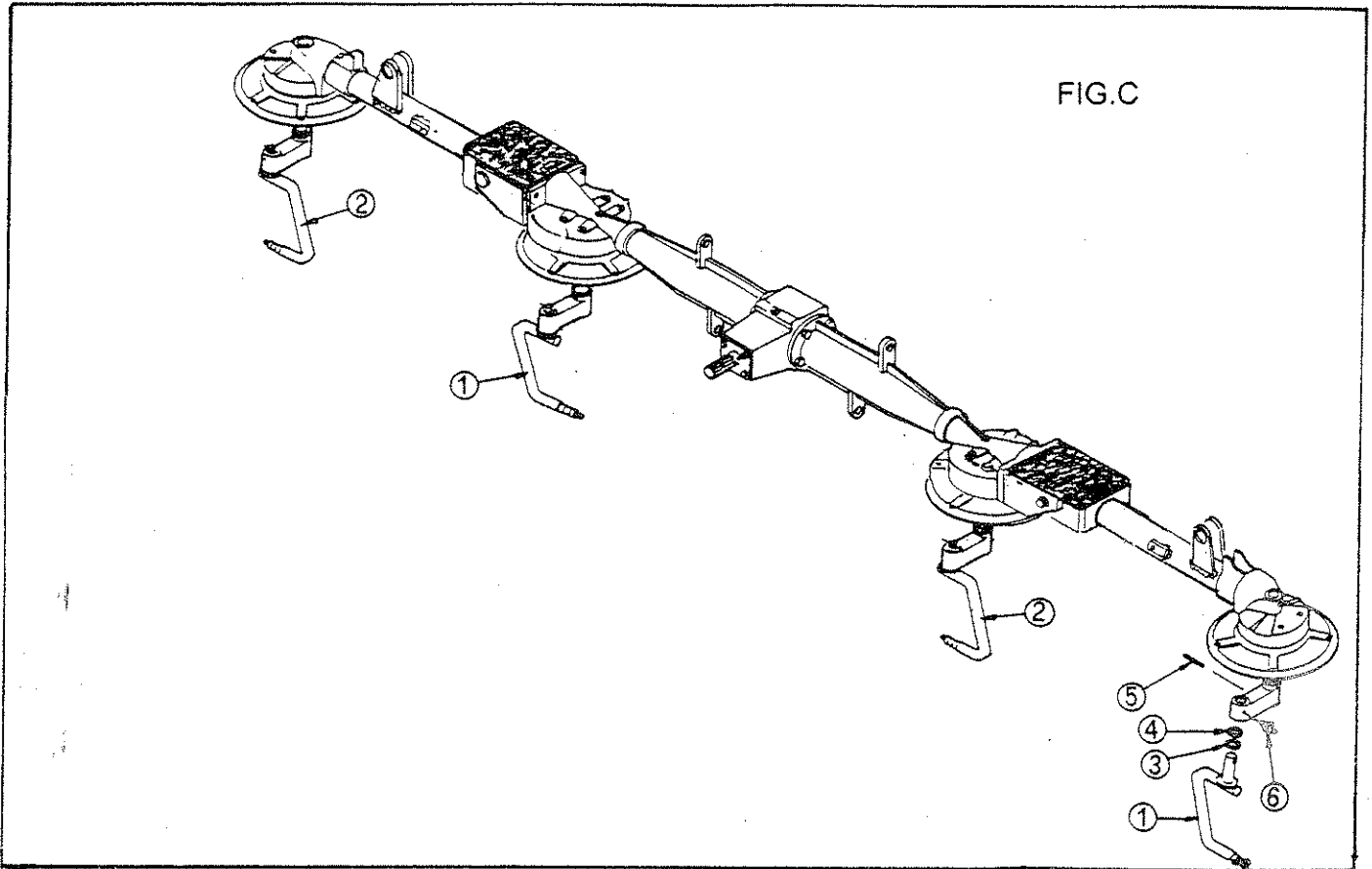

ASSEMBLY OF WHEELS ON 3-POINT HITCH-TYPE AND PULL-TYPE MACHINES (see Fig. D)

Attach the large hay guard disk 7 to wheel support A, followed by wheel 8, small disk 9 and washer 10, and fasten all with nut 11.

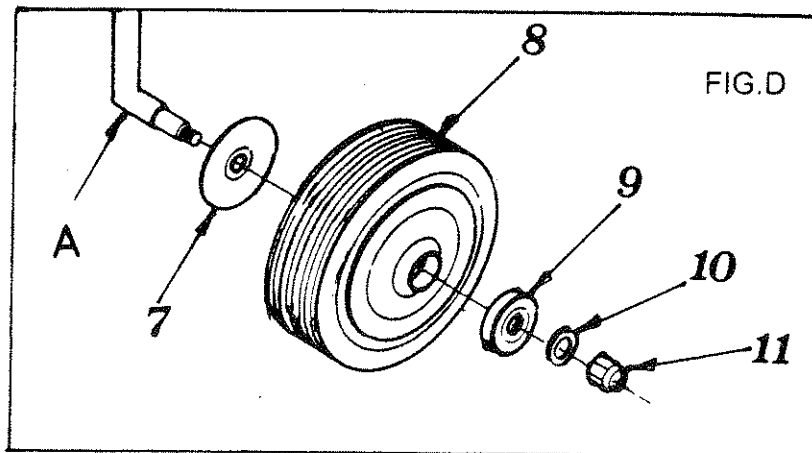

ASSEMBLY OF PULL-TYPE MACHINES

- 1) Attach casing 1 to the central housing using nuts 2.
- 2) Attach drawbar 3 to machine body A and fasten with rod 4 and split pins 5.
- 3) Screw fork 6 to the crank assembly 7.
- 4) Attach the crank assembly 7 to drawbar 3 and fasten with split pin 8. Screw grease nipples 9 into the crank attachment on drawbar 3 and into fork 6. NOTE: the crank assembly should be attached to the outside of drawbar 3 for the ST 520 and on the inside of drawbar 3 for ST 384 / 2G / 2GL.
- 5) Hook fork 6 onto the tab on assembly A and fasten with pin 10 and split pins 11.
- 6) Place cap 12 on drawbar parking stand 13.
- 7) Attach drawbar parking stand 13 to the drawbar 3 using pin 14 and clip 15.
- 8) Stabilize the machine by turning crank assembly 7.
- 9) Attach covers 16 using washers 17 and screws 18.
- 10) Attach tine bars 19 - 20 to the rotors. See pg 20/21. NOTE: The tine bars 19 - 20 must be attached before the guard rails 21 - 24 - 25.
- 11) Attach the central guard rail 21 to drawbar 3 using washers 22 and screws 23.
- 12) Attach the lateral guard rails 24 - 25 (R - L) using washers 26 and screws 27 - 28.
- 13) Apply caps 29 to guard rails 21 - 24 - 25.

Note: Detail H illustrates the assembly of brace J of guard rails 24 - 25 for the ST 384 spring and hydraulic lift version and for the ST 520 hydraulic lift version.

Detail K illustrates the assembly of guard rails 24 - 25 for the 2G and 2GL: in this case, the guard rails do not have brace J, thus they are attached only to the rotors with washers 26 and screws 27.

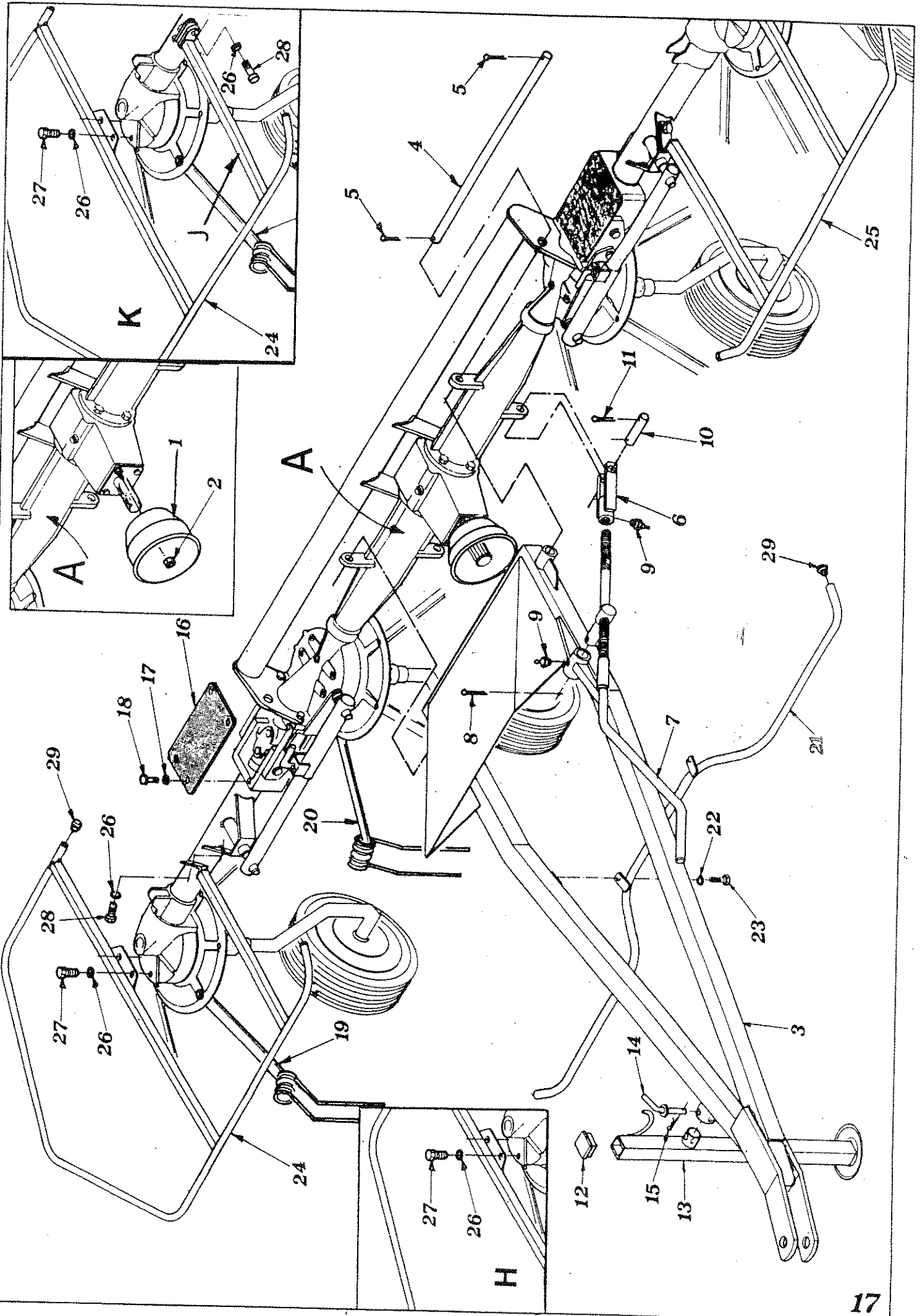

ASSEMBLY OF 3-POINT HITCH-TYPE MACHINES

- 1) Attach casing 1 to the central housing A and fasten using nuts 2.
- 2) Attach the 3-point hitch to the machine body to and fasten it using with rod 4 and split pins 5, attachment arms 6-7, screws 8-9-10, washers 11 and nuts 12-13. (Screws 10 and washers 11 are already attached to the machine body, so it is necessary to remove them previously and then screw them back into place.)
- 3) Place cap 14 on parking stand 15.
- 4) Attach parking stand 15 to the mount on the 3-point hitch and fasten using pin 16 and clips 17-18.
- 5) Attach covers 19 to the machine body assembly and fasten with washers 20 and screws 21.
- 6) Attach tine bars 22 - 23 to the rotors. See pg.20/21. NOTE: The tine bars 22 - 23 must be attached before proceeding with the attaching of guard rails 24 - 25.
- 7) Attach the lateral guard rails 24 - 25 (R - L) using washers 26 and screws 27 - 28.
- 8) Apply caps 29 to guard rails 24 - 25.

Note: Detail H illustrates the assembly of brace J of guard rails 24 - 25 for the ST 384 spring and hydraulic lift version and for the ST 520 hydraulic lift version.

Detail K illustrates the assembly of guard rails 24 - 25 for the 2G and 2GL: in this case, the guard rails do not have brace J, thus they are attached only to the rotors with washers 26 and screws 27.

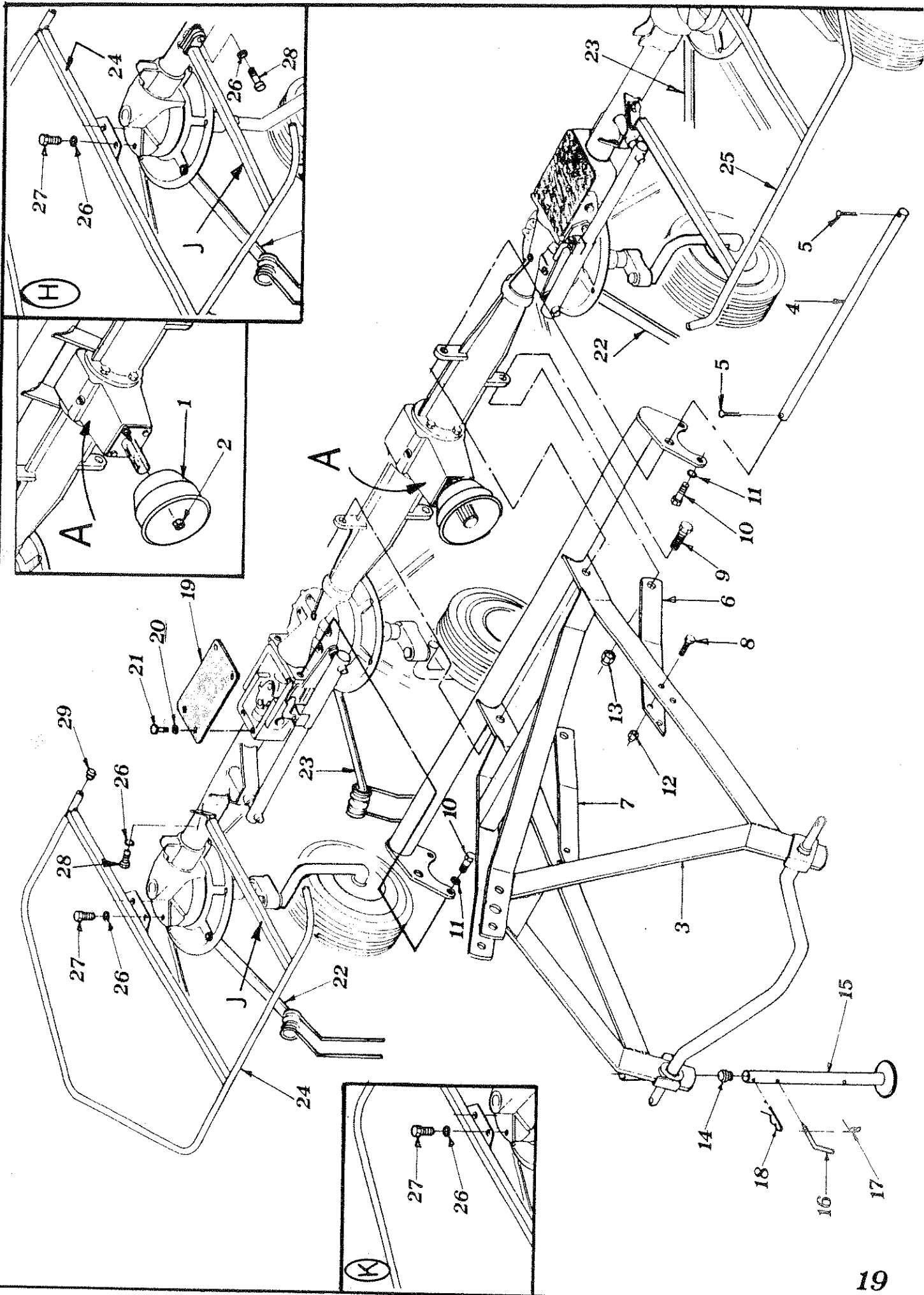

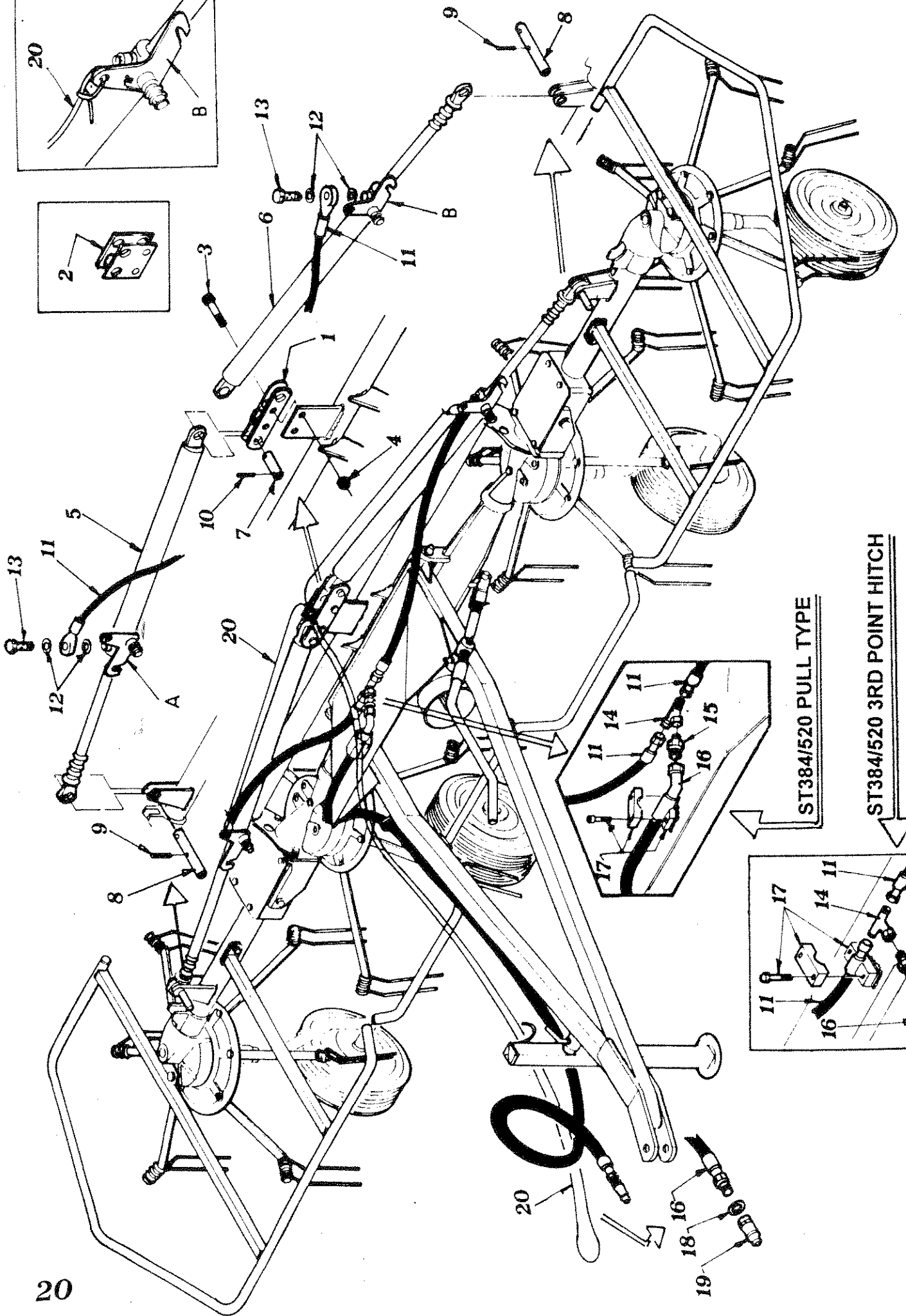
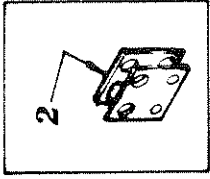
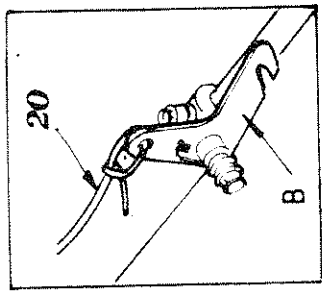

ST384/520 PULL TYPE

ST384/520 3RD POINT HITCH

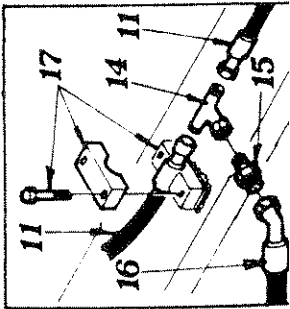
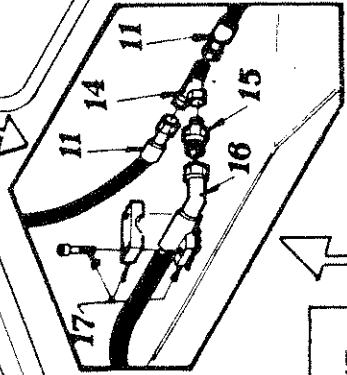

ASSEMBLAGE OF HYDRAULIC KIT

- Fit support 1 (ST/520) or 2 (ST/384) to the correct mounting and secure it with screws 3 and nuts 4.
- Fit cylinders 5-6 to the correct mountings and secure them with the short pins 7 and pins 10 at the bottom of the cylinder and with the long pins 8 and pins 9 at the top of the cylinder.
- Apply pipes 11 to cylinders 5-6 using washers 12 and nipples 13.
- Connect pipes 11 using pipe-fitting 14.
- Connect nipple 15 to pipe-fitting 14.
- Connect pipe 16 to nipple 15.
- ST 384/520 Towed: Secure pipe 16 with collar 17.
- ST 384/520 Supported: Secure pipe 11 with collar 17.
- Apply washer 18 and quick release 19 to pipe 16.
- Connect cord 20 to both ends of levers A-B of the cylinders 5-6.

NB. Assembly on a towed machine is represented, however, it is also valid for supported machines.

DIAGRAM OF TINE ASSEMBLY FOR THE ST/384-520

This description is valid for all versions of the ST/384-520 models.

- 1) You will find tine bars 1 (R) and 2 (L) in four bundles (2R-2L) of six pieces each for the ST/520, and two bundles (1R-1L) of eight pieces each for the ST/384.
- 2) Tine bars 1 (R) are attached to rotors A-C. Tine bars 2 (L) are attached to rotors B-D.
- 3) Attach tine bars 1-2 (R-L) to the respective rotors, placing holes E of tine bars 1-2 over the screws already in place on the lower central part of rotors A-B-C-D and fasten with nuts 3.
- 4) Insert screw 4 in the holes indicated on rotors A-B-C-D and in tine bars 1-2 (R-L) and fasten with nuts 5.

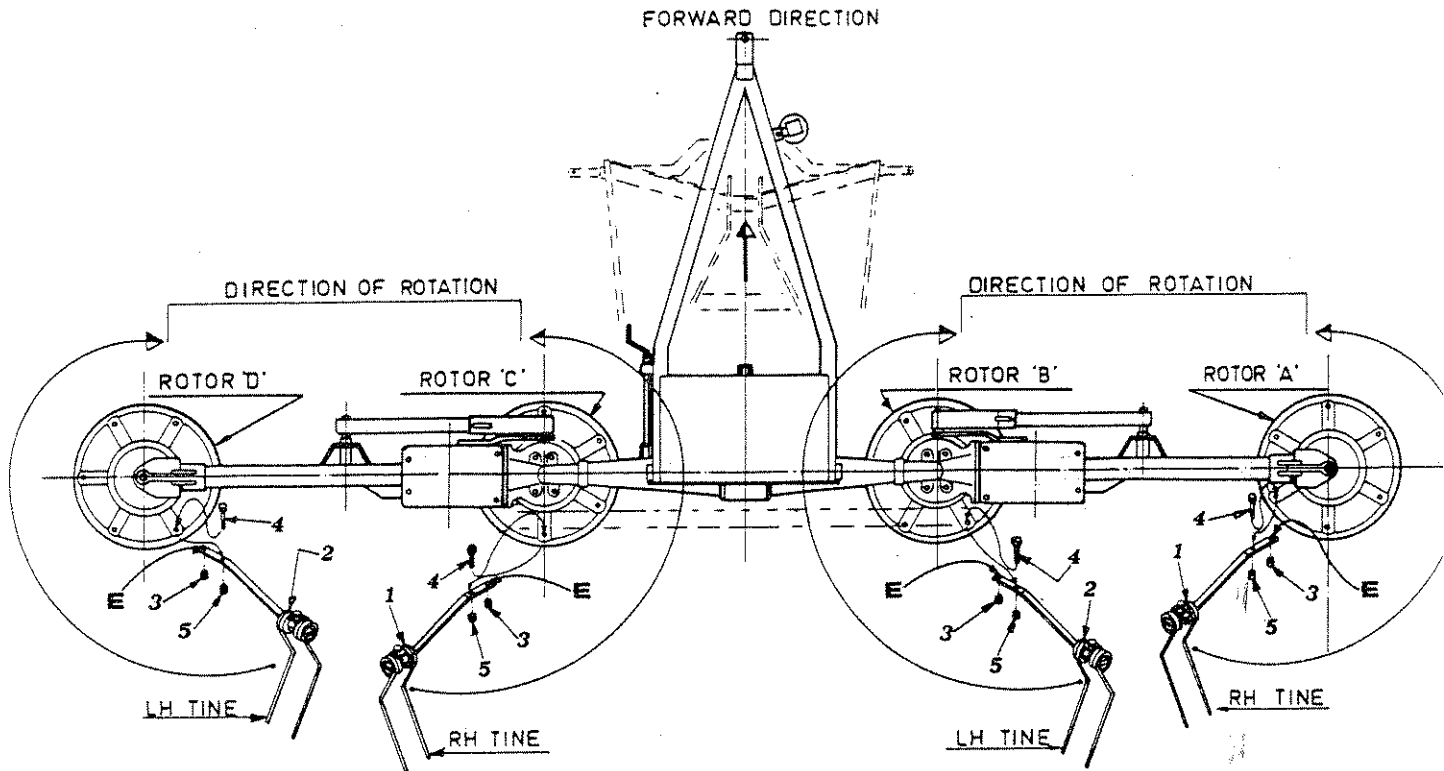

ASSEMBLY IS NOW COMPLETED, AND THE MACHINES SHOULD APPEAR AS SHOWN IN THE ILLUSTRATION.

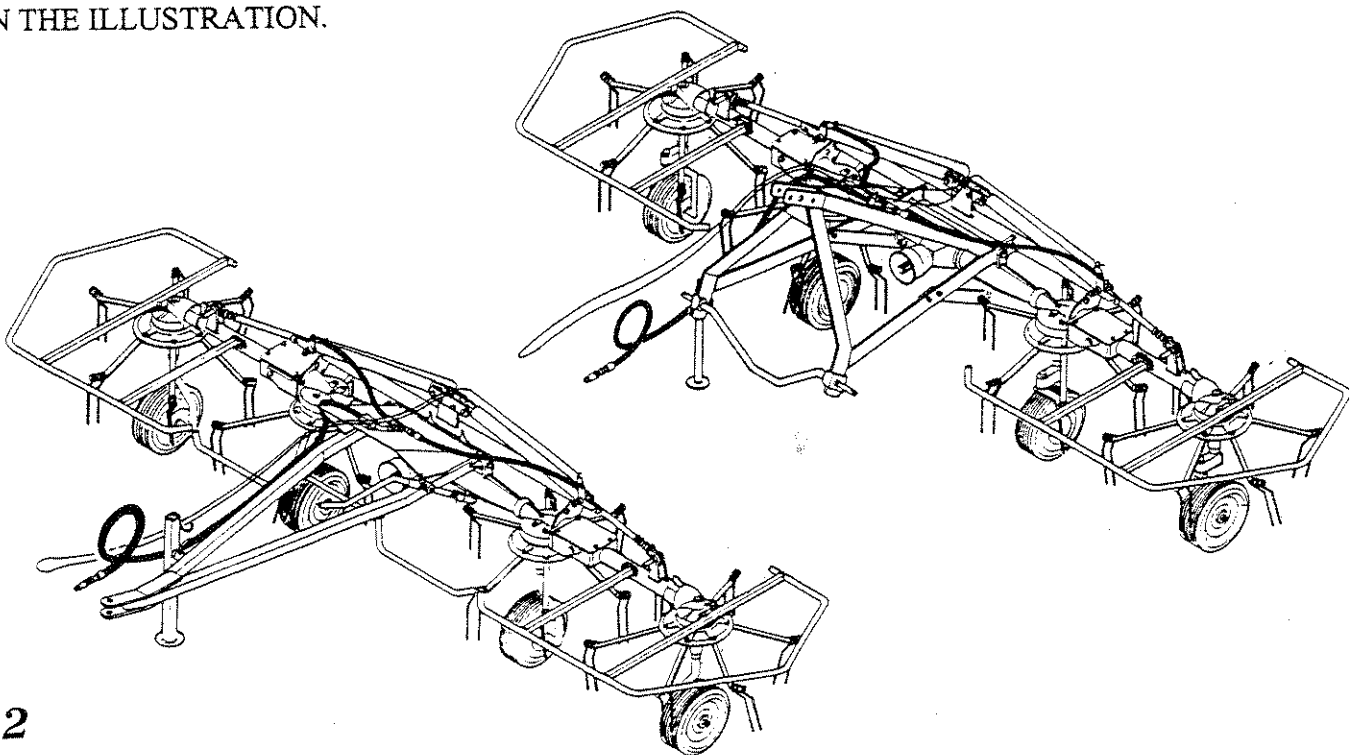

ADJUSTMENT , PREPARATION AND USE

MAINTENANCE

INTRODUCTION



DANGER III



Connection to the tractor is highly dangerous. Take great care and carry out the entire operation in strict compliance with the following instructions.

Nobody should go near the area between the tractor and the machine.

Check that all warning and danger signs are in place and legible.

Check that the tractor is in good running order. Check the engine oil, gearbox oil, brake fluid and cooling water levels as well as the tyre pressures.

Refer to the tractor operator's manual.

TRACTOR'S CONNECTION OFF 3RD POINT HITCH MACHINES

Reverse the tractor towards the machine lining up the tractor lifter arms (3) with the lateral connecting pins (2):

Switch off the tractor engine and apply the parking brake. Remove the ignition key from the instrument panel.

Fit the sockets at the ends of the lifting arms (3) over the pins (2) on the machine's 3-point linkage.

Secure them with split pins(4).

Fit the upper tie rod (5) into the bracket as shown and secure it with the pin (6) and split pin (7). Adjust the tie rod until the rotors of the machine are parallel with the ground.

To avoid excessive transversal play, adjust the tighteners (8) on the arms.

Approximately 50 mm (2 inches) of play is recommended on each side.

Level the machine horizontally by adjusting the tractor lifter arms (9).

Apply the pipe with quick release 12 to the correct mounting on the tractor's distributor. Link the end of cord 13 to the tractor's distributor controls.

Once the machine is attached to the tractor, put parking stand 1 in the transport position. To do this, remove clip 11 and extract pin 10. Next, raise parking stand 1 until hole A is above bushing B. Insert pin 10 in hole A of the parking stand and fasten with clip 11.

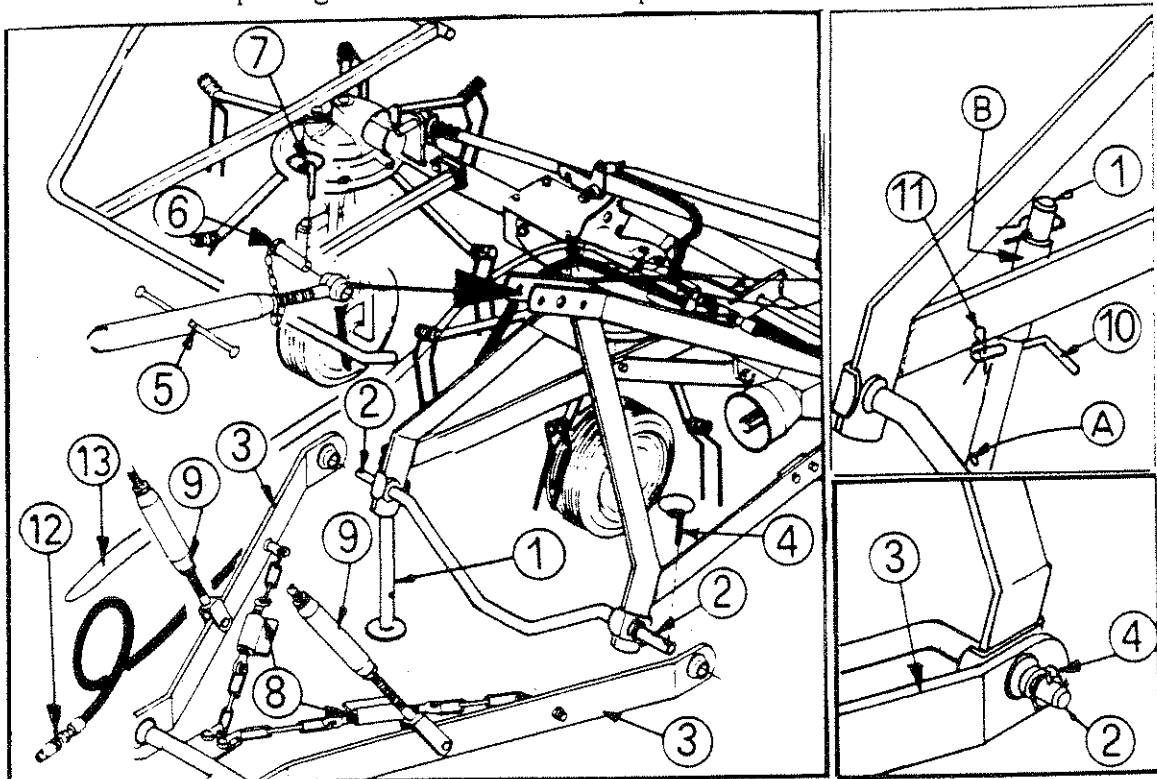

ATTACHMENT OF PULL-TYPE MACHINES TO THE TRACTOR

The attachment of pull-type machines to the tractor is very simple, as it is only necessary to couple the drawbar hitch 1 to the tractor hitch using a pin of appropriate size, strength and shape. Always use extreme care when reversing the tractor towards the machine.

Once the machine is hitched to the tractor, the drawbar parking stand must be raised from the parking position.

To do this, remove clip 4 and pin 3, and rotate the parking stand so that it is parallel with the drawbar frame. Fasten into the new position using pin 3 and clip 4.

Apply the pipe with quick release 5 to the correct mounting on the tractor's distributor. Link the end of cord 6 to the tractor's distributor controls.

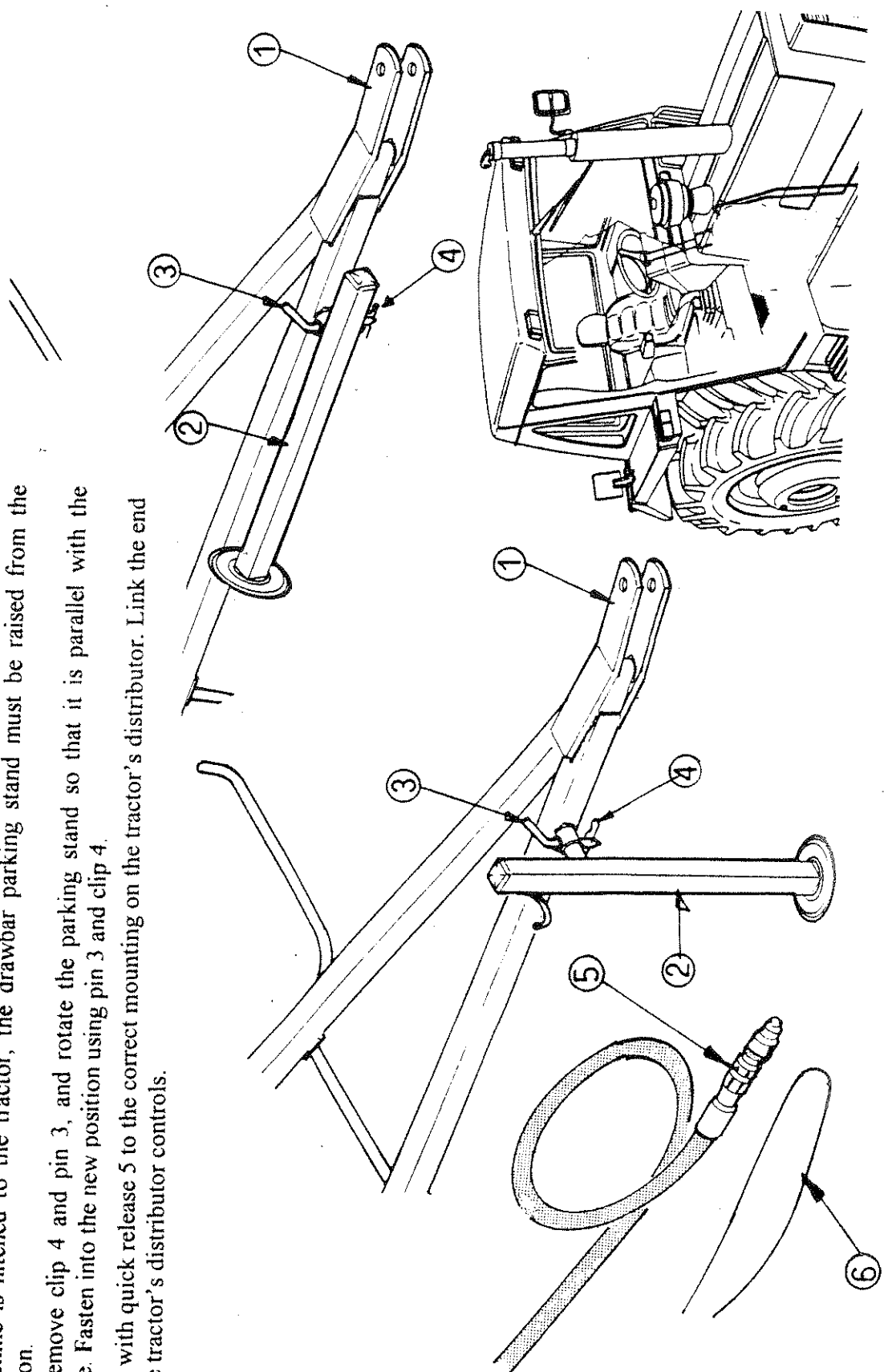

CONNECTING THE CARDAN SHAFT



DANGER!!!



More detailed information may be found in the Cardan shaft manual which, together with this manual, is an essential part of the accident-prevention documentation. It is your responsibility to read and comply with this documentation. If information given in this manual should conflict with that given in the Cardan shaft manual, you should follow the instructions given by the Cardan shaft manufacturer.



DANGER!!!



Fit the Cardan shaft and check that the shaft is connected correctly both at the tractor end and at the machine end. For more details, see the descriptions on the following pages.

If a safety system is provided, this should be fitted to the machine end, not to the tractor end.

During both transport and use, avoid conditions where the Cardan transmission shaft is extended to the maximum. In all working conditions, the telescopic tubes must overlap by at least $\frac{1}{3}$ of their length (Fig.1).

Conversely, when the Cardan shaft is contracted to the maximum, there should still be a gap of approximately 50 mm (2") (Fig.2).

Take particular care when connecting the two Cardan shaft end forks and make sure that they are fully secured.

This is achieved by inserting the safety pins and bolts (1) (Fig.3.) in the special slots(2) on the power takeoff shafts on both the tractor and machine ends.

A loose shaft could come apart and cause considerable mechanical damage and serious injury to persons.

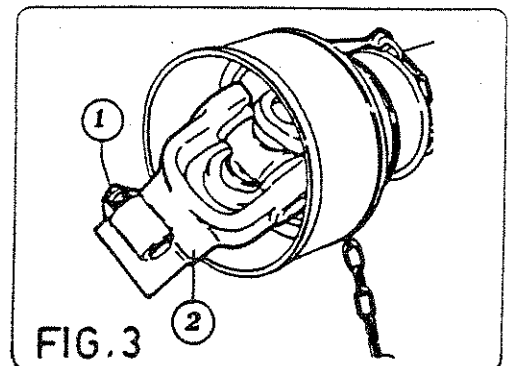
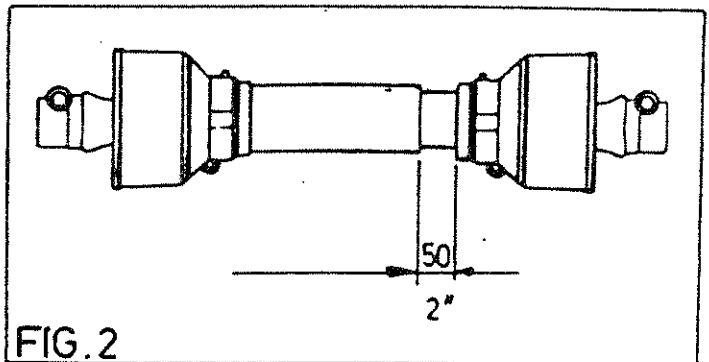
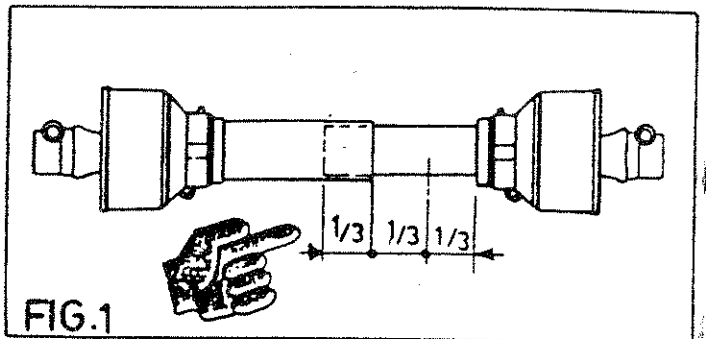

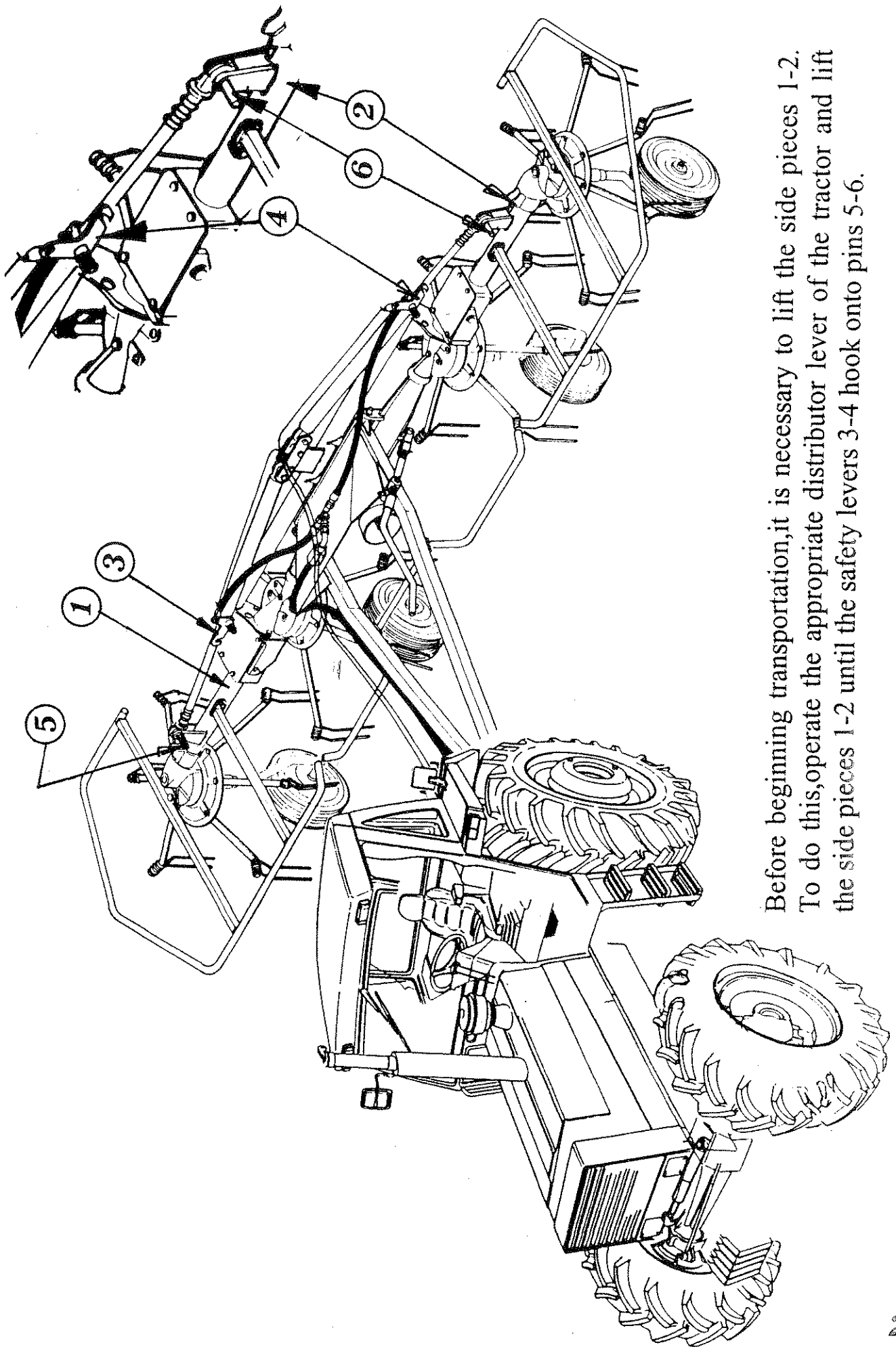

Before beginning transportation, it is necessary to lift the side pieces 1-2. To do this, operate the appropriate distributor lever of the tractor and lift the side pieces 1-2 until the safety levers 3-4 hook onto pins 5-6.

The machine ready for transport should appear as shown in the illustration.

THE 3-POINT HITCH MACHINES ALSO SHOW THIS CONFIGURATION.

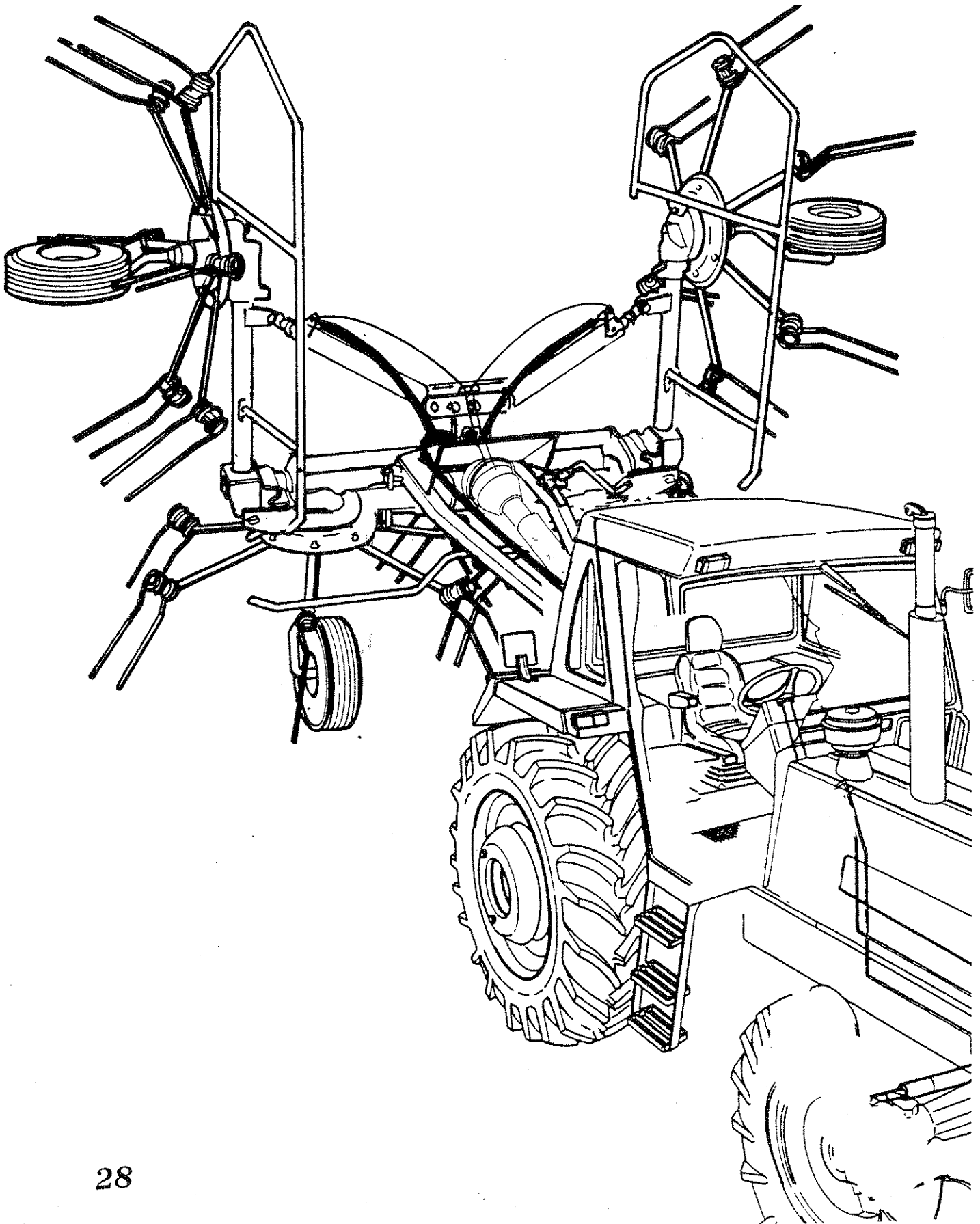

TRANSPORT BY ROAD



After the machine has been attached to the tractor as previously described and before transporting it to or from fields or any other workplace, the following instructions should be heeded:



Before setting off with the machine attached to the tractor, check the local road transport regulations.

During transport keep the machine fully raised with the power takeoff disengaged and the lifting unit immobilised.

Check that all guards, safety protection and locking split pins are in place, functioning and correctly fitted.

Ensure that nobody leans against, or climbs on to, the machine during transport. The MACHINE is an agricultural machine NOT designed for transporting persons or goods.

Consult the tractor maintenance-and-use manual where necessary.

Maintain constant control over the vehicle and ensure that you know how to stop the tractor quickly and switch off the engine.

When on a public road, observe all highway code regulations.

Drive near the edge of the road and try not to obstruct traffic.

Do not park the tractor and/or the machine where it might obstruct, or be a danger to, any public right of way.

Avoid going onto a public road if the tractor or machine is very dirty - you could leave a trail of soil, grass and other matter which could dirty the road and obstruct normal traffic.

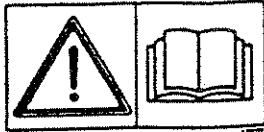

GENERAL INSTRUCTIONS FOR FIELD USE

Before starting work, familiarise yourself with the following general instructions:



CAUTION



Before using the machine ensure that all safety precautions are taken.

Check that all safety protection and guards are in place and working.

Inspect the work site in order to familiarise yourself with the terrain.

Do not start the tractor before being properly seated in the driving position.

Do not start the machine if it is damaged (or even if you only suspect it is damaged) and inform your nearest dealer of the problem and ask for assistance.

Do not allow yourself to become distracted when working - give your full attention to the job in hand.

Maintain constant control over the tractor and ensure that you know how to stop quickly and switch off the engine.

Caution when working on inclines. It is better to work from the bottom to the top of an incline (or from the top to the bottom), rather than across an incline where there is a risk of overturning. Check and heed the instructions supplied by the tractor manufacturer, especially those concerning the maximum incline on which it is possible to work.

It is advisable to reduce speed when working and manoeuvring on inclines and only to change speed and direction gradually. Do not make sudden stops or starts.

Do not work on wet or slippery grass or terrain, or anywhere where grip is poor. If this is unavoidable, work at a slow speed so as to ensure operator safety.

Always switch off the tractor engine, apply the parking brake and remove the ignition key whenever you have to attend to the machine to make adjustments or to remove grass and other objects which might be entangled in the machine.

Before leaving the tractor, disengage the power takeoff, lower the machine until its wheels are on the ground and put the hydraulic directional control lever into the locked position.

Never go near the rotors until they have completely stopped moving.

Never attempt to make adjustments to the machine while it is running. Always stop the machine before carrying out any such work. Do not oil the machine when it is running or is connected to the power takeoff.

Do not use the control levers as handholds since they can move and do not give a secure grip. Furthermore, any involuntary movement of a control lever can cause unintentional movement of the tractor or machine.

USE IN THE FIELD

In order to lower the side pieces 1-2, operate the appropriate distributor lever of the tractor and retract cylinders 3-4 until the lock levers 5-6, released by pulling cord 7, allow side pieces 1-2 to descend.

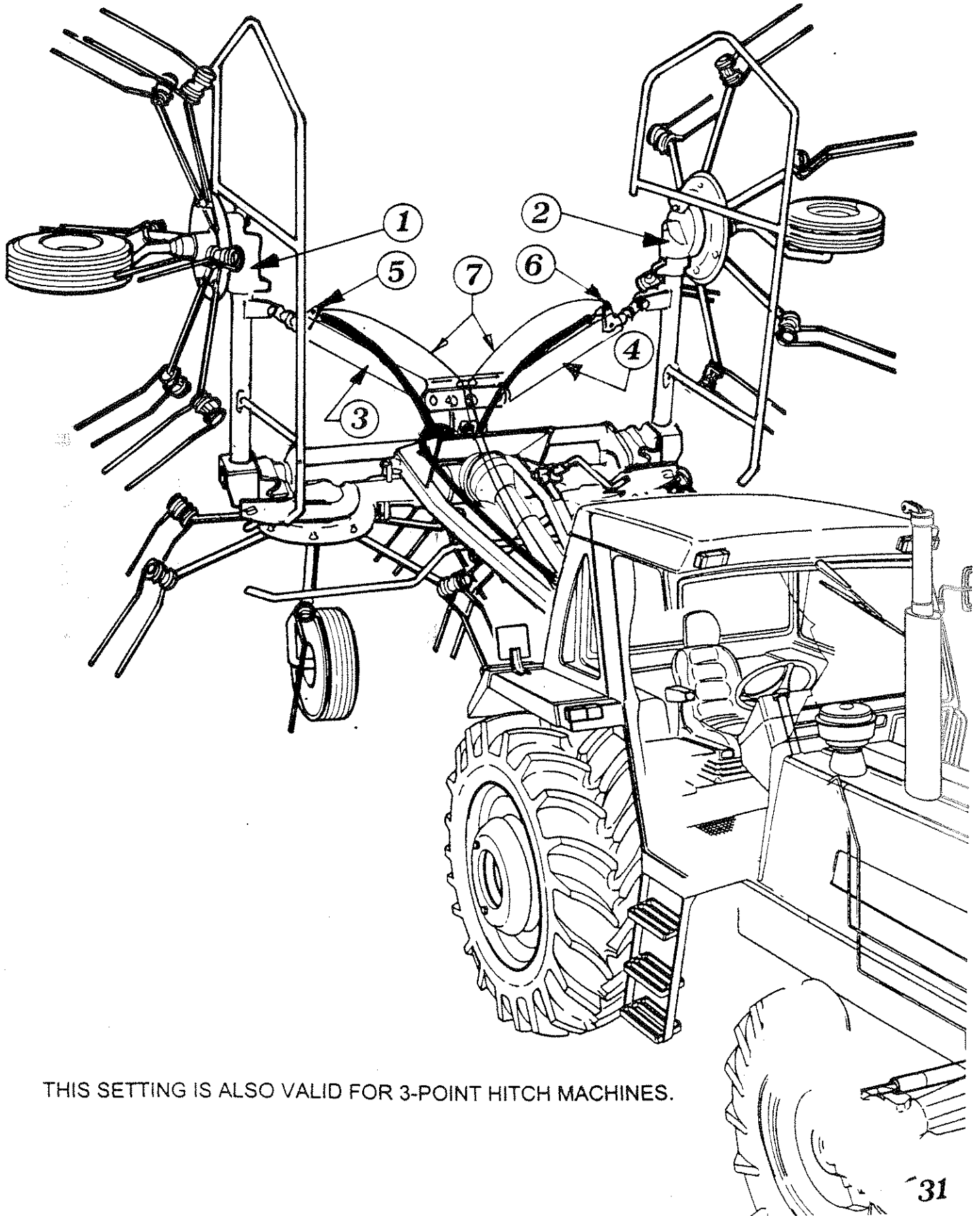

THIS SETTING IS ALSO VALID FOR 3-POINT HITCH MACHINES.

2) NOTE APPLYING TO ALL MODELS

The machine is operating properly when tines 1 at the front of the machine brush the ground. To do this, adjust top link 2 on the 3-point hitch for carry-type machines, or turn crank 3 for pull-type machines.

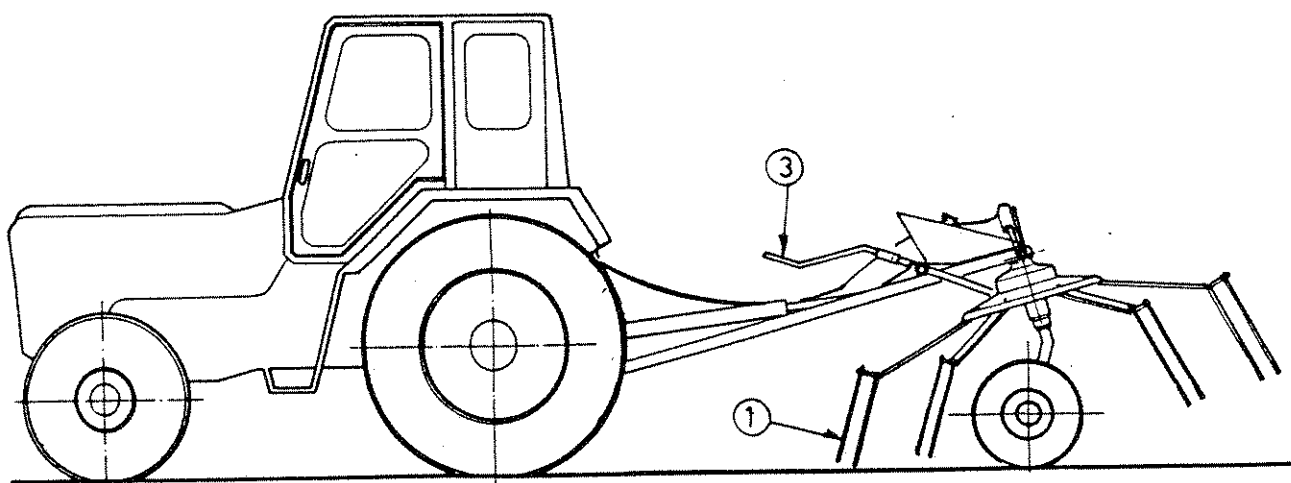
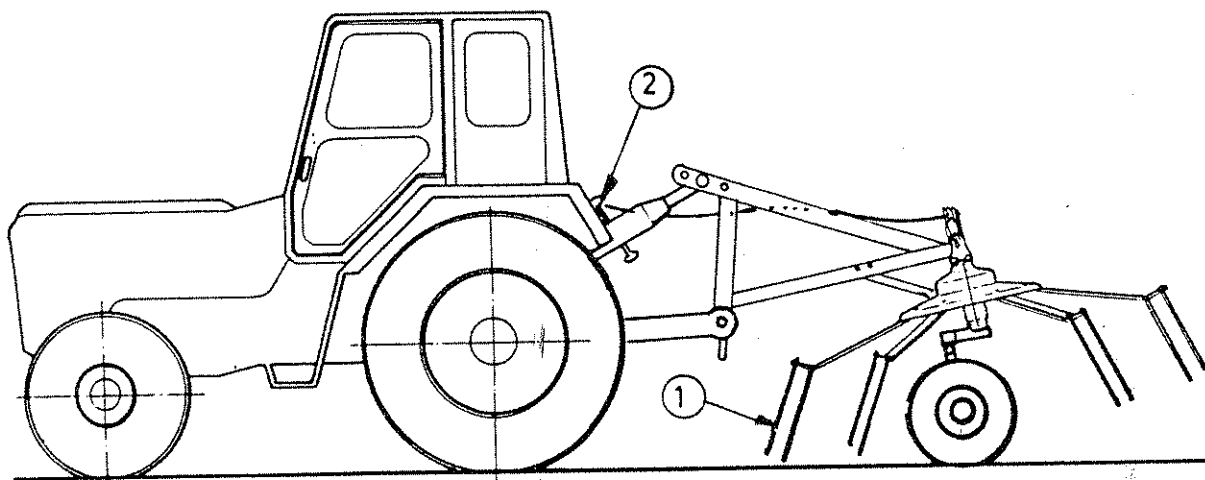

TEMPORARY PARKING

- 1) Choose a flat,hard open space away from frequented areas if possible.
- 2) Lower the machine until its wheels touch the ground.(3rd point hitch machine)
- 3)Put the hydraulic directional control lever on the tractor into the locked position.(3rd point hitch machine)
- 4) Switch off the engine,leaving the tractor in gear.
- 5) Apply the parking brake.
- 6) Remove the ignition key.
- 7) Put the parking stand in the parking position (ST 384/520 only).
- 8) Adjust the top link (3rd point hitch machines) or turn the angle adjustment crank (pull-type machines) so that the weight of the machine is on the parking stand,thus avoiding the risk of having the machine tip over backwards.
- 9) Disconnect the cardan shaft at the tractor end.
- 10) Unhitch the top link and the lifting arms (3rd point hitch machines) or the tractor-drawbar coupling pin (pull type machines).

MAINTENANCE DIRECTIONS

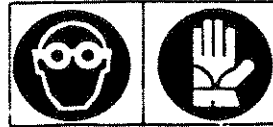
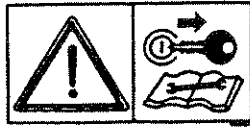

DANGER III



All cleaning, lubrication and maintenance operations must be carried out with the machine disconnected from the tractor. In an emergency with the machine still connected to the tractor, switch off the engine, apply the parking brake, disengage the power takeoff and remove the ignition key from the instrument panel.

Regular, correct maintenance and proper operation are the basic prerequisites for the long-term efficiency and safe operation of the machine.

Pay special attention to all instructions given on signs located on the machine.

All maintenance should be carried out in an area having the proper equipment readily available and in good condition. This area must always be kept clean and dry and must have enough surrounding space to facilitate operations. Any work must be carried out by trained personnel. Contact the dealer nearest to you. Respect the warnings and procedures for maintenance and technical assistance given in this manual.

Do not use petrol, solvents or other flammable liquids as detergents.

Use commercial non-flammable and non-toxic solvents, authorised by competent bodies.

Do not use compressed air or water at high pressure to clean the machine. If this is unavoidable, then wear goggles with side protection and limit the pressure as much as possible. When the work is finished, and with the machine disconnected from the tractor, inspect and check the machine completely.

GENERAL INSTRUCTIONS FOR REPAIR WORK

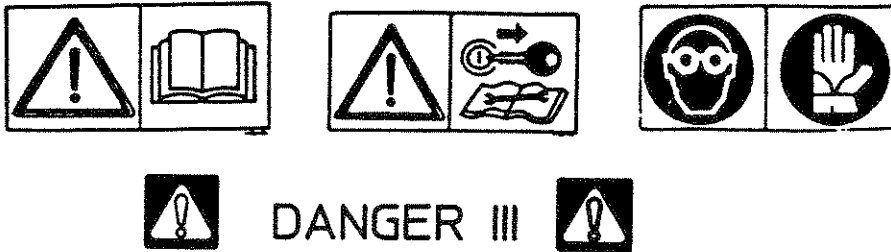

Any repair work must be carried out with the machine at rest and disconnected from the tractor.

Do not carry out welding without authorisation and instructions from the manufacturers.

Disconnect the machine from the tractor before any welding work in order not to damage the battery. Always use a protective mask, goggles and gloves when welding, sanding or grinding or when using a hammer or drill.

Always work on the machine out of doors. If you have to operate the machine when connected to the tractor in an enclosed area (for example when testing after repair and/or maintenance), ensure that there is sufficient ventilation so as to prevent noxious exhaust gases accumulating.

In order to acquire the necessary control and to operate in safety, practise various manoeuvres by simulating those required in the workplace with the help of an experienced person.

If you activate the machine while it is raised from the ground, make sure there is nobody standing nearby or in a dangerous position.

LAYING UP FOR EXTENDED PERIODS

At the end of the season, or when an extended period of inactivity is envisaged, it is advisable to:

Clean the machine following instructions and allow it to dry.

Check it carefully and replace any damaged or worn parts.

Thoroughly tighten all screws and bolts.

Grease the machine thoroughly and then cover it completely and lay it up in a dry place.

It is to the user's advantage to carry out these operations carefully. In this way, he will have a machine in perfect condition when work is restarted.

On recommencing work, repeat all the proper checks so as to be certain of working in conditions of maximum safety.

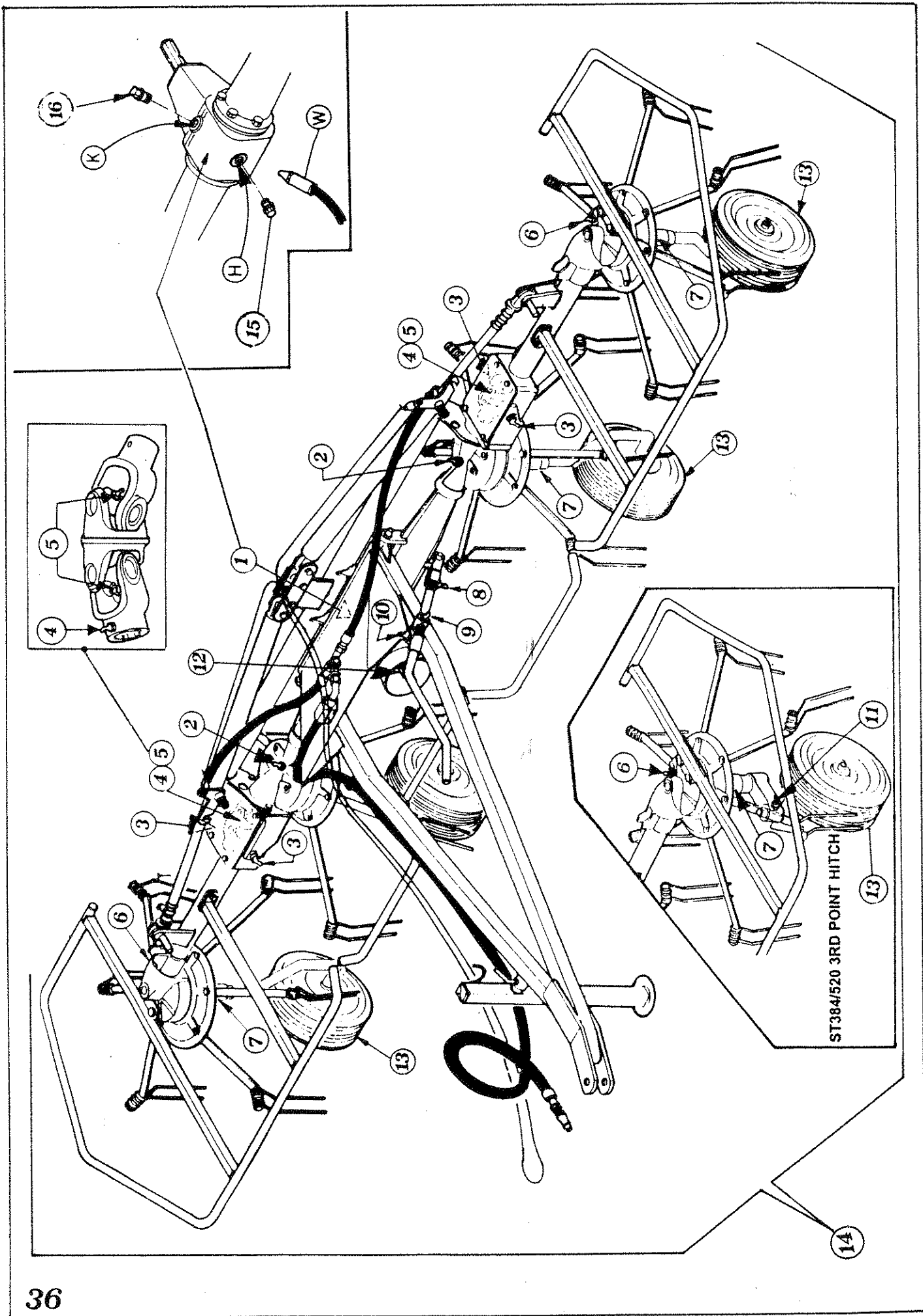

ST384/520 3RD POINT HITCH

MAINTENANCE POINTS

| ITEM | QTY | DESCRIPTION | OPERATION | EVERY HOURS | NOTES |
|-----------|-----|---|-----------------|----------------|------------------------|
| 1 | 1 | CENTRAL HOUSING | lubricate | 100 | see note A |
| 2 | 2 | CENTRAL ROTORS | " " | 50 | ST 384/520 |
| 3 | 4 | SWIVEL HINGE PINS | " " | 50 | ST 384/520 |
| 4 | 2 | KEYED COUPLING FORK | " " | 8 | ST 384/520 |
| 5 | 4 | UNIVERSAL JOINT | " " | 8 | ST 384/520 |
| 6 | 2 | LATERAL ROTORS | " " | 50 | — |
| 7 | 4/2 | ROTOR HUBS | " " | 30 | — |
| 8 | 1 | ADJUSTMENT FORK | " " | 30 | ST 384/520 pull type |
| 9 | 1 | STRUT PIN | " " | 30 | pull-type machines |
| 10 | 1 | STRUT BUSHING | " " | 30 | ST 384/520 pull type |
| 11 | 4 | WHEEL SUPPORT HUBS | " " | 30 | 3-point hitch machines |
| 12 | 1 | P T O. | clean/lubricate | see note B | with brushes, etc. |
| 13 | 4 | WHEELS | check pressure | see note C | inflate to 45 psi |
| 14 | — | General checking of bolts, security pins and split pins to be carried out initially after the first 8 hours of use. Subsequently every 50 hours and whenever the machine is laid up for extended periods. | | | |

NOTE A:

COMPLETE LUBRICATION OF THE CENTRAL HOUSING 1

- a) The complete lubrication of housing 1 is done the first time at the Sitrex plant, after which it must be topped up periodically, as according to the lubrication points table. A complete change or fill is necessary only for the replacement and/or repairing of the entire housing or internal parts. In this case, it is necessary to: remove caps 12 - 13 and inject the grease, using grease pump W, into hole H until the grease comes out of hole K. Then screw caps 12 - 13 back into place on housing 1.
- b) Periodic checking and topping up of housing 1

Every 100 hours of working time, check and top up central housing 1.

It is a good practice, however, to check the condition and quantity of grease after all long periods of inactivity, especially when starting to work again after the winter break

To top up the grease in central housing 1, it is necessary to: remove cap 13 and inject the proper amount of grease into hole K using grease pump W. Then screw cap 13 back into place on housing 1.

CARDAN SHAFT MAINTENANCE

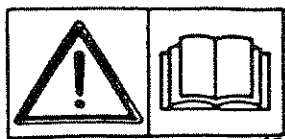

More detailed information may be found in the Cardan shaft manual which, together with this manual, forms an essential part of the accident-prevention documentation. It is your responsibility to read and comply with this documentation. If information given in this manual conflicts with that given in the Cardan shaft manual, you should follow the instructions given by the Cardan shaft manufacturer.

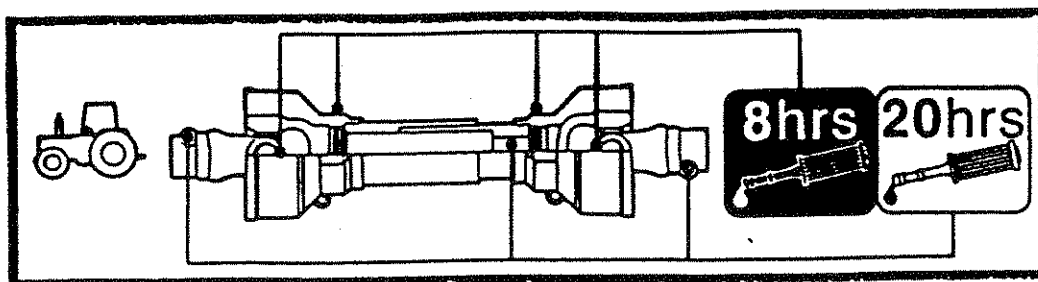

MAINTENANCE OF SLIDING PARTS

DISMANTLING

1) Turn the two eccentric pins on the ferrule until the protective cone comes free.

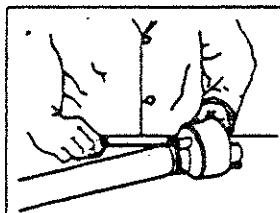

2) Withdraw the shaft protective guard.

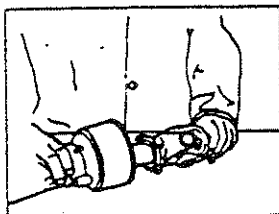

3) Check the condition of the ferrule and all protective parts.

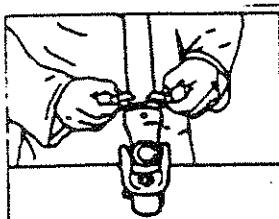

ASSEMBLY

4) Lubricate supporting ferrule seating.

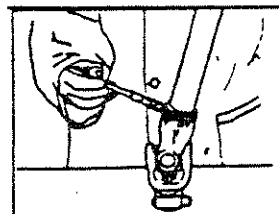

5) Refit the supporting ferrule.

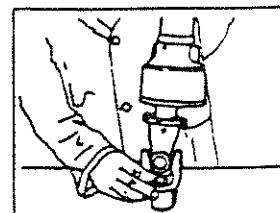

6) Reattach the protective guard to the cardan shaft by turning the eccentric pins on the supporting ferrule.

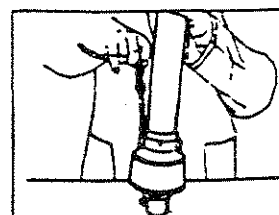

SPARE PARTS LIST

FOR CORRECT SPARE PARTS ORDER IT IS NECESSARY TO SPECIFY: TABLE NUMBER, REFERENCE, PART NUMBER, DESCRIPTION AND QUANTITY OF PARTS REQUIRED.

ITEMS DESCRIBED AS R.H. AND L.H. ARE MEANT FACING REAR OF MACHINE.

TABLE NO. 920078

40

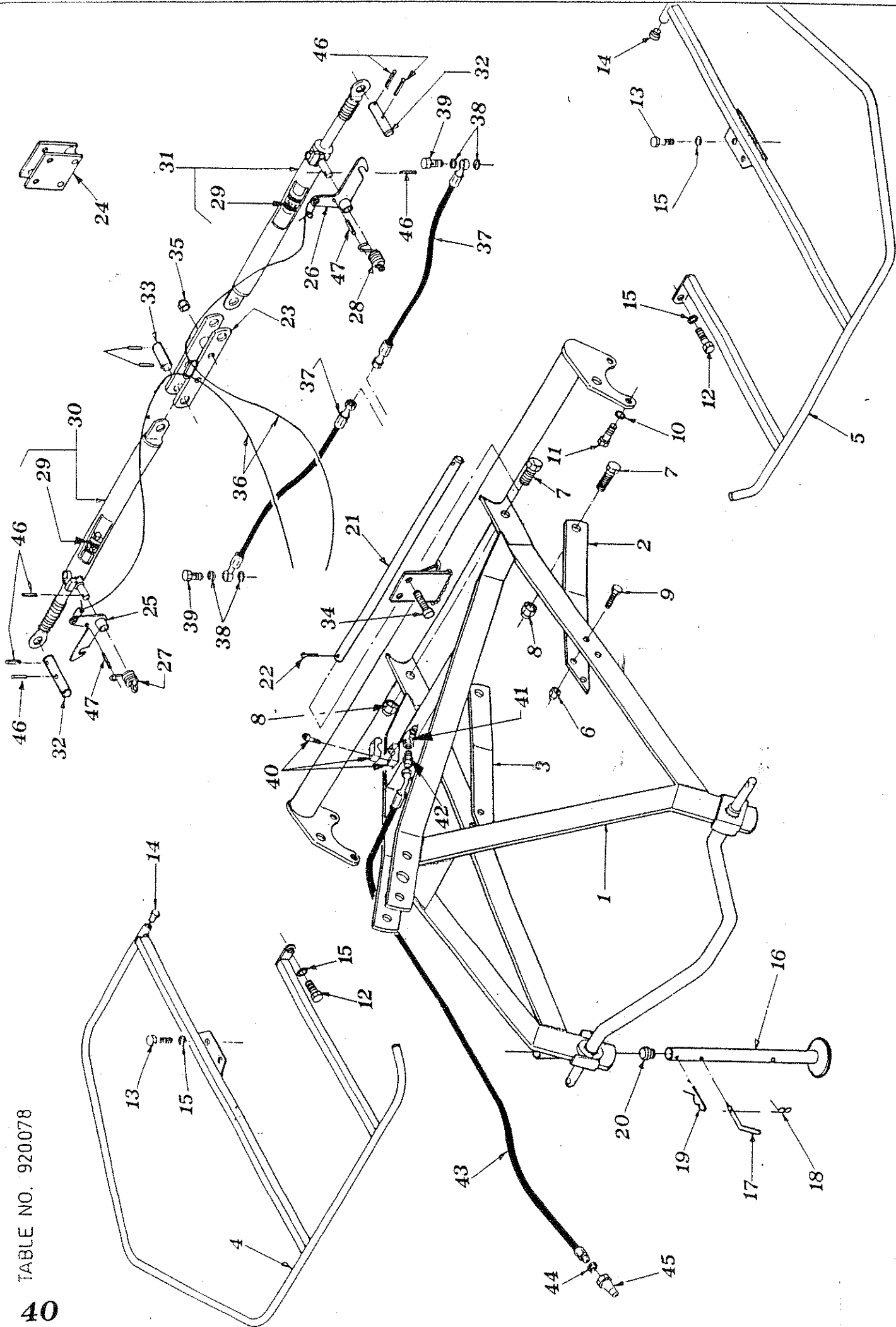
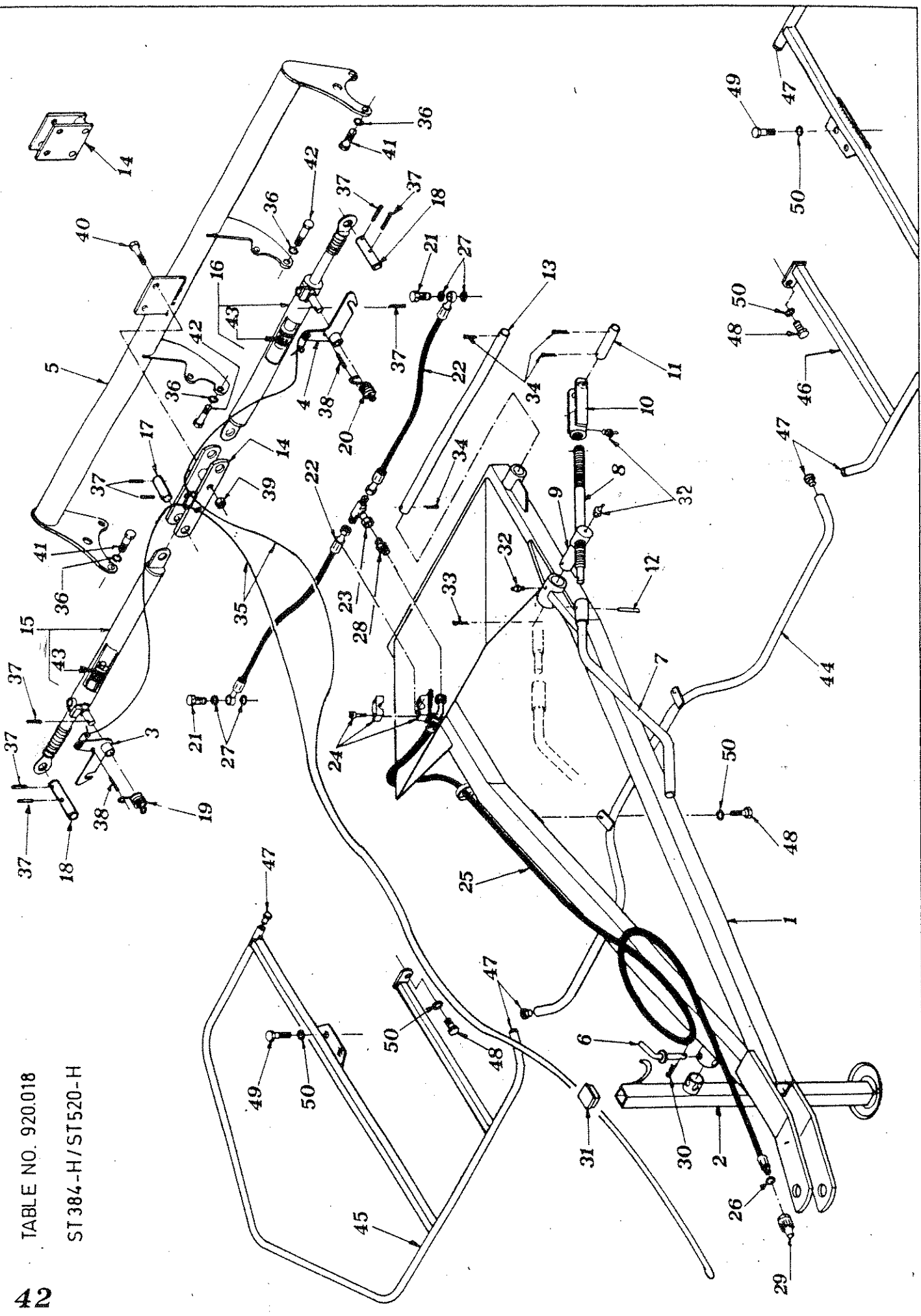

TABLE NO. 920.078

ST/ 384 ST 520 - 3RD POINT HITCH -HYDRO

| ITEM | ST384 Q.ty | ST520 Q.ty | PART NO | DESCRIPTION | NOTE |
|------|---------------|---------------|---------|------------------------|--------|
| 1 | 1 | - | 210.041 | 3RD POINT HITCH | ST/384 |
| 1 | - | 1 | 210.040 | 3RD POINT HITCH | ST/520 |
| 2 | 1 | - | 200.425 | LH TIE ROD | ST/384 |
| 2 | - | 1 | 200.426 | LH TIE ROD | ST/520 |
| 3 | 1 | - | 200.428 | RH TIE ROD | ST/384 |
| 3 | - | 1 | 200.429 | RH TIE ROD | ST/520 |
| 4 | 1 | - | 210.078 | RH LATERAL GUARD | ST/384 |
| 4 | - | 1 | 210.074 | RH LATERAL GUARD | ST/520 |
| 5 | 1 | - | 210.079 | LH LATERAL GUARD | ST/384 |
| 5 | - | 1 | 210.075 | LH LATERAL GUARD | ST/520 |
| 6 | 4 | 4 | 600.077 | NUT | |
| 7 | 2 | 2 | 600.578 | SCREW | |
| 8 | 2 | 2 | 600.240 | NUT | |
| 9 | 4 | 4 | 600.443 | SCREW | |
| 10 | 4 | 4 | 600.633 | WASHER | |
| 11 | 4 | 4 | 600.442 | SCREW | |
| 12 | 2 | 2 | 600.770 | SCREW | |
| 13 | 4 | 4 | 600.441 | SCREW | |
| 14 | 4 | 4 | 600.854 | PLUG | |
| 15 | 6 | 6 | 600.634 | WASHER | |
| 16 | 1 | - | 210.026 | STAND | ST/384 |
| 16 | - | 1 | 210.064 | STAND | ST/520 |
| 17 | 1 | 1 | 200.328 | PIN | |
| 18 | 1 | 1 | 600.019 | PIN | |
| 19 | 1 | 1 | 600.020 | PIN | |
| 20 | 1 | 1 | 200.309 | PLUG | |
| 21 | 1 | - | 200.430 | PIN | ST/384 |
| 21 | - | 1 | 200.431 | PIN | ST/520 |
| 22 | 2 | 2 | 600.112 | SPLIT PIN | |
| 23 | - | 1 | 200.859 | HITCH | ST/520 |
| 24 | 1 | - | 210.010 | HITCH | ST/384 |
| 25 | 1 | 1 | 210.098 | RH COUPLER | |
| 26 | 1 | 1 | 210.099 | LH COUPLER | |
| 27 | 1 | 1 | 210.093 | RH SPRING | |
| 28 | 1 | 1 | 210.094 | LH SPRING | |
| 29* | 2 | 2 | 600.895 | SET OF GASKET | |
| 30 | 1 | 1 | 210.091 | RH CYLINDER | |
| 31 | 1 | 1 | 210.092 | LH CYLINDER | |
| 32 | 2 | 2 | 210.103 | PIN | |
| 33 | 2 | 2 | 200.860 | PIN | |
| 34 | 2 | 2 | 600.826 | SCREW | |
| 35 | 2 | 2 | 600.077 | NUT | |
| 36 | 1 | 1 | 210.009 | ROPE | |
| 37* | 2 | 2 | 600.821 | HOSE | |
| 38* | 4 | 4 | 600.819 | COPPER WASHER | |
| 39* | 2 | 2 | 600.820 | SCREW | |
| 40* | 1 | 1 | 600.822 | PIPE STOP, COMPLETE | |
| 41* | 1 | 1 | 600.880 | UNION TEE | |
| 42* | 1 | 1 | 600.883 | NIPPLES | |
| 43* | 1 | 1 | 600.882 | HOSE | |
| 44* | 1 | 1 | 600.269 | COPPER WASHER | |
| 45* | 1 | 1 | 600.273 | QUICK COUPLING | |
| 46 | 10 | 10 | 600.538 | PIN | |
| 47 | 2 | 2 | 600.773 | PIN | |
| * | 1 | 1 | 210.018 | HYDRAULIC COMPLETE KIT | |

TABLE NO. 920.018
ST 384-H/ST 520-H



| TABLE NO. 920.018 | | | | | |
|----------------------------|---------------|---------------|---------|------------------------|--------|
| ST/ 384 ST 520 - PULL TYPE | | | | | |
| ITEM | ST384 Q.ty | ST520 Q.ty | PART NO | DESCRIPTION | NOTE |
| 1 | 1 | - | 210.034 | DRAWBAR | ST/384 |
| 1 | 1 | 1 | 210.033 | DRAWBAR | ST/520 |
| 2 | 1 | 1 | 200.946 | STAND | |
| 3 | 1 | 1 | 210.098 | RH COUPLER | |
| 4 | 1 | 1 | 210.099 | LH COUPLER | |
| 5 | 1 | - | 210.283 | REINFORCEMENT,REAR | ST/384 |
| 5 | - | 1 | 210.305 | REINFORCEMENT,REAR | ST/520 |
| 6 | 1 | 1 | 200.959 | PIN | |
| 7 | 1 | 1 | 200.438 | HANDLE | |
| 8 | 1 | 1 | 200.766 | TIEROD | |
| 9 | 1 | 1 | 200.768 | PIN | |
| 10 | 1 | 1 | 200.769 | FORK | |
| 11 | 1 | 1 | 200.442 | PIN | |
| 12 | 1 | 1 | 600.580 | PIN | |
| 13 | 1 | - | 210.319 | PIN | ST/384 |
| 13 | - | 1 | 200.445 | PIN | ST/520 |
| 14 | 1 | - | 210.010 | HITCH | ST/384 |
| 14 | - | 1 | 200.859 | HITCH | ST/520 |
| 15 | 1 | 1 | 210.091 | RH CYLINDER | |
| 16 | 1 | 1 | 210.092 | LH CYLINDER | |
| 17 | 2 | 2 | 200.860 | PIN | |
| 18 | 2 | 2 | 210.103 | PIN | |
| 19 | 1 | 1 | 210.093 | RH SPRING | |
| 20 | 1 | 1 | 210.094 | LH SPRING | |
| 21* | 2 | 2 | 600.820 | SCREW | |
| 22* | 2 | 2 | 600.821 | PIPE | |
| 23* | 1 | 1 | 600.880 | UNION TEE | |
| 24* | 1 | 1 | 600.822 | PIPE STOP,COMPLETE | |
| 25* | 1 | 1 | 600.894 | PIPE | |
| 26* | 1 | 1 | 600.269 | COPPER WASHER | |
| 27* | 4 | 4 | 600.819 | COPPER WASHER | |
| 28* | 1 | 1 | 600.883 | NIPPLES | |
| 29* | 1 | 1 | 600.273 | QUICK COUPLING | |
| 30 | 1 | 1 | 600.019 | PIN | |
| 31 | 1 | 1 | 600.817 | PLUG | |
| 32 | 3 | 3 | 600.124 | GREASE NIPPLE | |
| 33 | 1 | 1 | 600.548 | SPLIT PIN | |
| 34 | 4 | 4 | 600.112 | SPLIT PIN | |
| 35 | 1 | 1 | 210.009 | ROPE | |
| 36 | 8 | 8 | 600.633 | WASHER | |
| 37 | 10 | 10 | 600.538 | PIN | |
| 38 | 2 | 2 | 600.773 | PIN | |
| 39 | 2 | 2 | 600.077 | NUT | |
| 40 | 2 | 2 | 600.826 | SCREW | |
| 41 | 6 | 6 | 600.442 | SCREW | |
| 42 | 4 | 4 | 600.153 | SCREW | |
| 43 | 1 | 1 | 600.895 | SET OF GASKET | |
| 44 | 1 | - | 200.960 | GUARD | ST/384 |
| 44 | - | 1 | 200.958 | GUARD | ST/520 |
| 45 | 1 | - | 210.078 | RH LATERAL GUARD | ST/384 |
| 45 | - | 1 | 210.074 | RH LATERAL GUARD | ST/520 |
| 46 | 1 | - | 210.079 | LH LATERAL GUARD | ST/384 |
| 46 | - | 1 | 210.075 | LH L,ATERAL GUARD | ST/520 |
| 47 | 6 | 6 | 600.854 | PLUG | |
| 48 | 4 | 4 | 600.770 | SCREW | |
| 49 | 4 | 4 | 600.441 | SCREW | |
| 50 | 8 | 8 | 600.634 | WASHER | |
| * | 1 | 1 | 210.090 | HYDRAULIC COMPLETE KIT | |

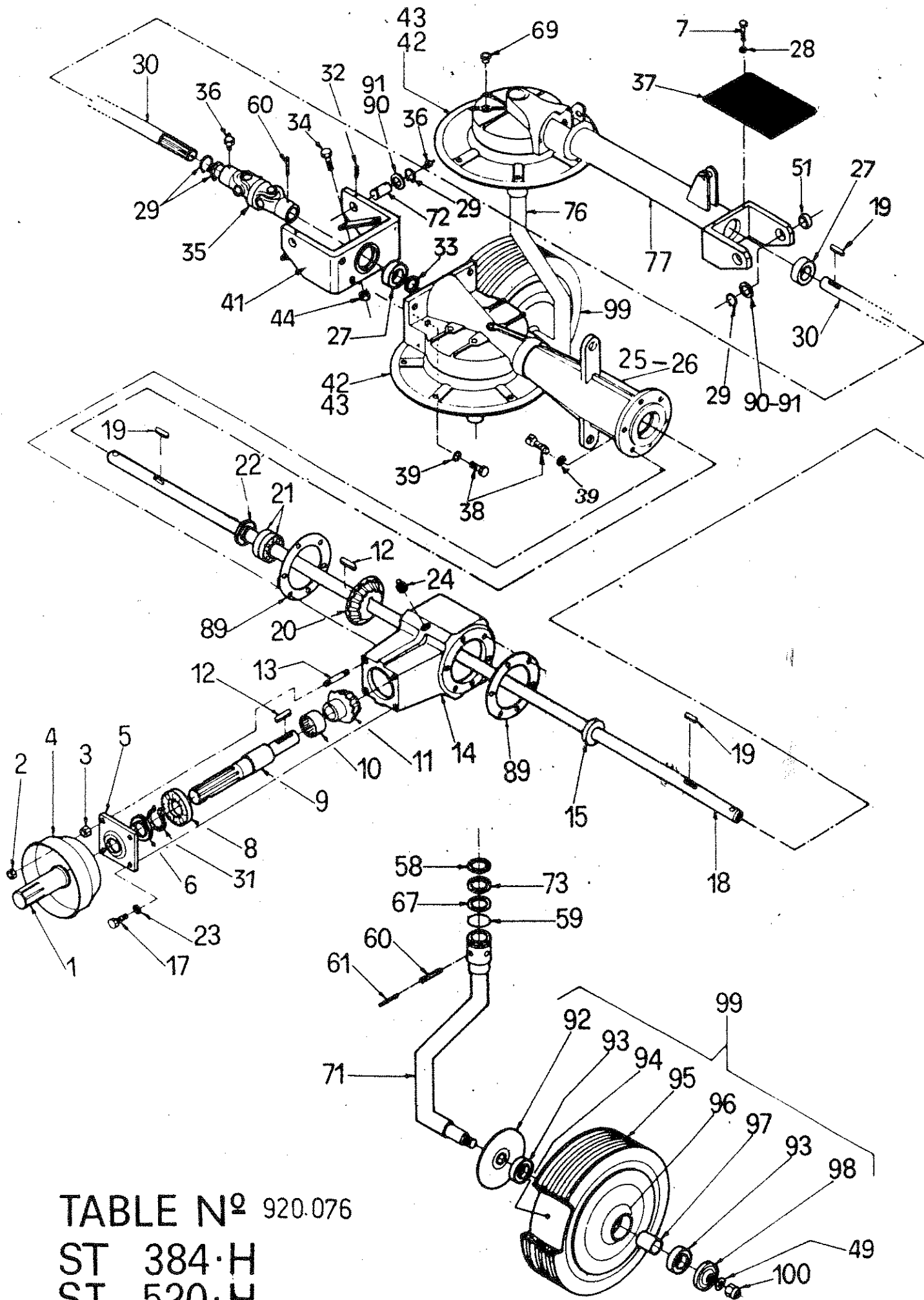
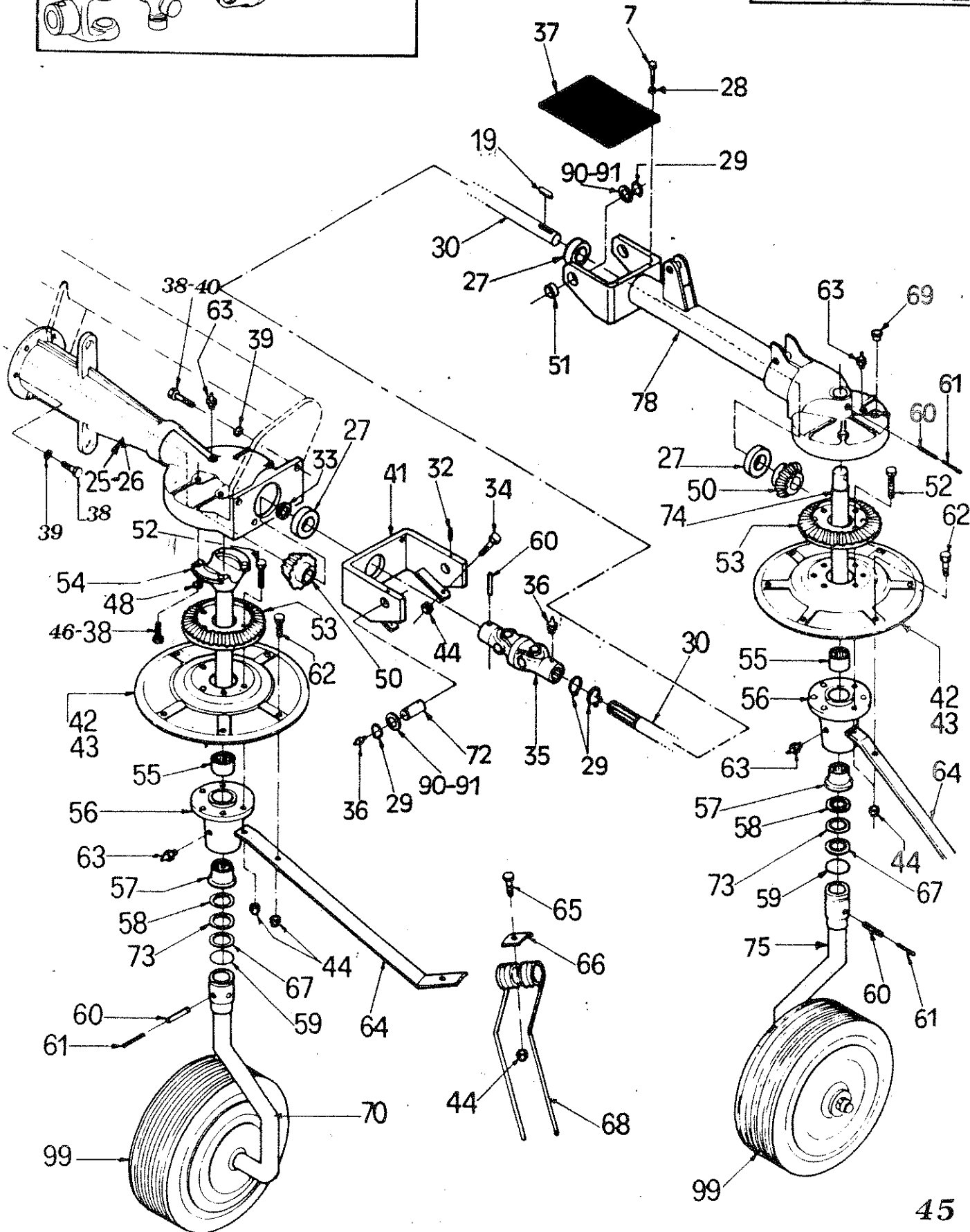
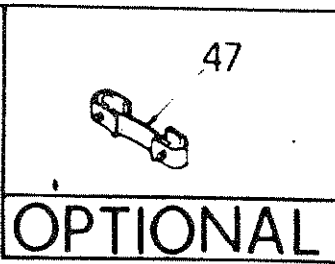
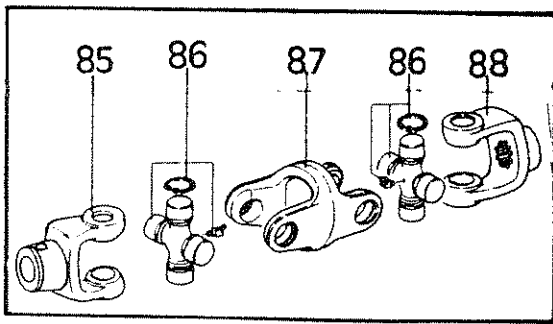

TABLE N^o 920.076

ST 384·H

ST 520·H



| TABLE NO.920.076 | | | | | |
|-------------------|---------------|---------------|-----------|---------------|--------|
| ST384/ST520 HYDRO | | | | | |
| ITEM | ST384 Q.ty | ST520 Q.ty | PART NO | DESCRIPTION | NOTE |
| 1 | 1 | 1 | 600.172 | SHAFT GUARD | |
| 2 | 2 | 2 | 600.037 | NUT | |
| 3 | 1 | 2 | 600.552 | NUT | |
| 4 | 2 | 1 | 600.681 | HOOD | |
| 5 | 1 | 1 | 200.395 | GEARBOX CAP | |
| 6 | 1 | 1 | 600.555 | OIL RETAINER | |
| 7 | 8 | 8 | 600.061 | SCREW | |
| 8 | 1 | 1 | 600.327 | BEARING | |
| 9 | 1 | 1 | 200.396 | SHAFT | |
| 10 | 1 | 1 | 600.557 | BEARING | |
| 11 | 1 | 1 | 200.397 | SHAFT | |
| 12 | 2 | 2 | 600.556 | TAP | |
| 13 | 2 | 2 | 600.558 | BOLT | |
| 14 | 1 | 1 | 200.390 | GEARBOX | |
| 15 | 1 | 1 | 600.561 | OIL RETAINER | |
| 17 | 2 | 2 | 600.222 | SCREW | |
| 18 | 1 | - | 200.949 | DRIVE SHAFT | |
| 18 | - | 1 | 200.853 | DRIVE SHAFT | |
| 19 | 4 | 4 | 600.559 | TAP | |
| 20 | 1 | 1 | 200.400 | CROWN | |
| 21 | 1 | 2 | 600.579 | BEARING | |
| 22 | 1 | 1 | 600.582 | OIL RETAINER | |
| 23 | 2 | 2 | 600.228 | SPRING WASHER | |
| 24 | 2 | 2 | 600.560 | CAP | |
| 25 | - | 2 | 210.056 | ROTOR AXLE | |
| 26 | 2 | - | 200.452 | ROTOR AXLE | |
| 27 | 6 | 6 | 600.609 | BEARING | |
| 28 | 8 | 8 | 600.115 | WASHER | |
| 29 | 12 | 12 | 600.611 | SNAP RING | |
| 30 | 2 | - | 200.950/A | LATERAL SHAFT | |
| 30 | - | 2 | 200.852/A | LATERAL SHAFT | |
| 31 | 1 | 1 | 600.333 | SNAP RING | |
| 32 | 4 | 4 | 600.809 | SCREW | |
| 33 | 2 | 2 | 200.851 | SHIM | |
| 34 | 4 | 4 | 600.153 | SCREW | |
| 35 | 2 | 2 | 200.857 | JOINT | |
| 36 | 6 | 6 | 600.124 | GREASE NIPPLE | |
| 37 | 2 | 2 | 200.862 | GUARD | |
| 38 | 20 | 24 | 600.615 | SCREW | |
| 39 | 20 | 20 | 600.633 | WASHER | |
| 40 | 4 | 4 | 600.442 | SCREW | |
| 41 | 2 | 2 | 200.921 | HINGE | |
| 42 | - | 4 | 200.408 | TINE DISC | |
| 43 | 4 | - | 200.466 | TINE DISC | |
| 44 | 52 | 76 | 600.077 | NUT | |
| 46 | 4 | - | 600.004 | SCREW | ST/384 |

TABLE NO.920.076
ST384/ST520 HYDRO

| ITEM | ST384 Q.ty | ST520 Q.ty | PART NO | DESCRIPTION | NOTE |
|------|---------------|---------------|-----------|----------------------|----------|
| 47 | 16 | 24 | 200.640 | TINE LOCK | OPTIONAL |
| 48 | 8 | 8 | 600.049 | WASHER | |
| 49 | 4 | 4 | 600.080 | NUT | |
| 50 | 4 | 4 | 200.464 | PINION | |
| 51 | 4 | 4 | 600.808 | BUSHING | |
| 52 | 16 | 24 | 600.564 | SCREW | |
| 53 | 4 | - | 200.627 | CROWN | |
| 53 | - | 4 | 200.470 | CROWN | |
| 56 | 4 | - | 200.472/A | HUB | |
| 56 | - | 4 | 200.410/A | HUB | |
| 57 | 4 | 4 | 600.567 | BEARING | |
| 58 | 4 | 4 | 200.411 | SHIM | |
| 59 | 4 | 4 | 600.568 | GASKET | |
| 60 | 8 | 8 | 600.541 | SPRING PIN | |
| 61 | 6 | 6 | 600.562 | SPRING PIN | |
| 62 | 16 | 24 | 600.616 | SCREW | |
| 63 | 8 | 8 | 600.247 | GREASE NIPPLE | |
| 64 | 16 | - | 200.473 | TINE ARM | |
| 64 | - | 24 | 200.403 | TINE ARM | |
| 65 | 16 | 24 | 600.688 | SCREW | |
| 66 | 16 | 24 | 200.402 | PLATE | |
| 67 | 4 | 4 | 200.490 | SHIM | |
| 68 | 16 | 24 | 200.401 | TINE | |
| 69 | 4 | 4 | 600.896 | PLUG | |
| 70 | 1 | 1 | 210.593 | L.H. CENTER SUPPORT | |
| 71 | 1 | 1 | 210.592 | R.H. CENTER SUPPORT | |
| 72 | 4 | 4 | 200.850 | PIN | |
| 73 | 4 | 4 | 200.475 | SHIM | |
| 74 | 2 | 2 | 200.407 | PIN | |
| 75 | 1 | 1 | 210.591 | L.H. LATERAL SUPPORT | |
| 76 | 1 | 1 | 210.590 | R.H. LATERAL SUPPORT | |
| 77 | 1 | - | 210.006 | R.H. SIDE AXLE | |
| 77 | - | 1 | 200.922 | R.H. SIDE AXLE | |
| 78 | 1 | - | 210.007 | L.H. SIDE AXLE | |
| 78 | - | 1 | 200.928 | L.H. SIDE AXLE | |
| 85 | 2 | 2 | 600.813 | FORK | |
| 86 | 4 | 4 | 600.814 | CROSS, COMPLETE | |
| 87 | 2 | 2 | 600.815 | CENTER JOINT | |
| 88 | 2 | 2 | 600.816 | SPLINED FORK | |
| 89 | 2 | 2 | 200.405 | GASKET | |
| 90 | 4 | 4 | 200.272 | SHIM | |
| 91 | 4 | 4 | 200.273 | SHIM | |
| 92 | 4 | 4 | 210.596 | DUST COVER, INNER | |
| 93 | 8 | 8 | 600.602 | BEARING | |
| 94 | 4 | 4 | 610.274 | TUBE | |
| 95 | 4 | 4 | 610.275 | TIRE | |
| 96 | 4 | 4 | 610.273 | RIM | |
| 97 | 4 | 4 | 200.415 | SPACER | |
| 98 | 4 | 4 | 200.416 | DUST COVER, OUTER | |
| 99 | 4 | 4 | 610.272 | TIRE ASSY | |
| 100 | 4 | 4 | 600.080 | NUT | |

TABLE NO. 920.015/A

ST384 ST520

3RD POINT HITCH

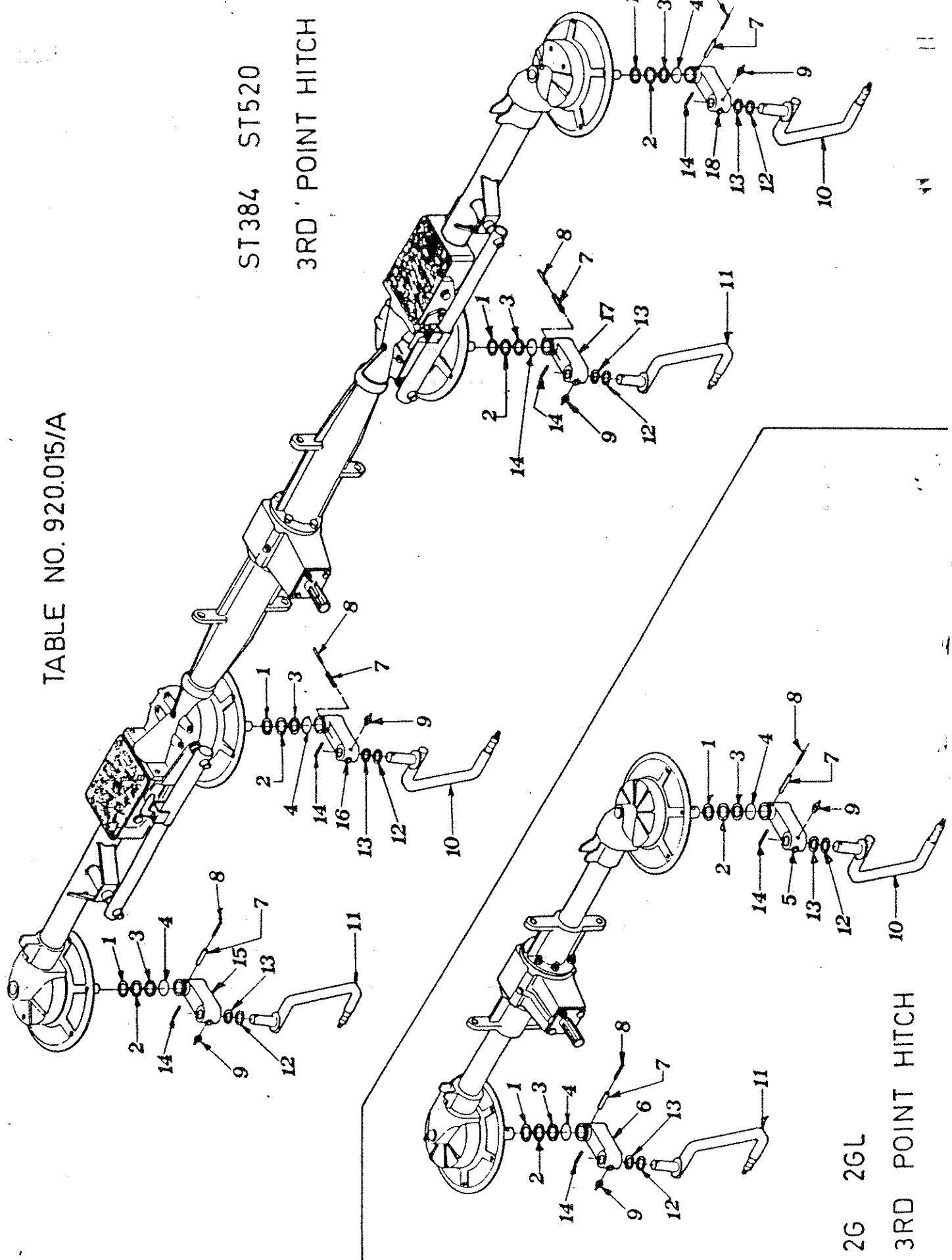

2G 2GL

3RD POINT HITCH

TABLE NO.920.015/A

2/G 2/GL ST/384 ST/520 3RD POINT HITCH(WHEEL BRACKET)

| ITEM | 2G/2GL Q.ty | ST384-520 Q.ty | PART NO | DESCRIPTION | NOTE |
|------|----------------|-------------------|-----------|----------------------|------------|
| 1 | 2 | 4 | 200.411 | SHIM | |
| 2 | 2 | 4 | 200.475 | SHIM | |
| 2 | 2 | 4 | 200.419 | SHIM | |
| 3 | 2 | 4 | 200.490 | SHIM | |
| 4 | 2 | 4 | 600.568 | GASKET | |
| 5 | 1 | * | 200.468 | SUPPORT,L.H. | 2G-2GL |
| 6 | 1 | * | 200.467 | SUPPORT,R.H. | 2G-2GL |
| 7 | 2 | 4 | 600.541 | SPRING PIN | |
| 8 | 2 | 4 | 600.562 | SPRING PIN | |
| 9 | 2 | 4 | 600.124 | GREASE NIPPLE | |
| 10 | 1 | * | 210.632 | L.H. TIRE BRACKET | 2G-2GL |
| 10 | * | 2 | 210.632 | L.H. TIRE BRACKET | ST/384-520 |
| 11 | 1 | * | 210.631 | R.H. TIRE BRACKET | 2G-2GL |
| 11 | * | 2 | 210.631 | R.H. TIRE BRACKET | ST/384-520 |
| 12 | 2 | 4 | 200.273 | SHIM | |
| 13 | 2 | 4 | 200.272 | SHIM | |
| 14 | 2 | 4 | 600.539 | SPRING PIN | |
| 15 | * | 1 | 200.417/1 | R.H. LATERAL SUPPORT | ST/384-520 |
| 16 | * | 1 | 200.417 | R.H. CENTER SUPPORT | ST/384-520 |
| 17 | * | 1 | 200.418 | L.H. CENTER SUPPORT | ST/384-520 |
| 18 | * | 1 | 200.418/1 | L.H. LATERAL SUPPORT | ST/384-520 |

CARDAN SHAFT B3 090E + LW3

PART NO.610.097

ST 384/520 3RD POINT HITCH

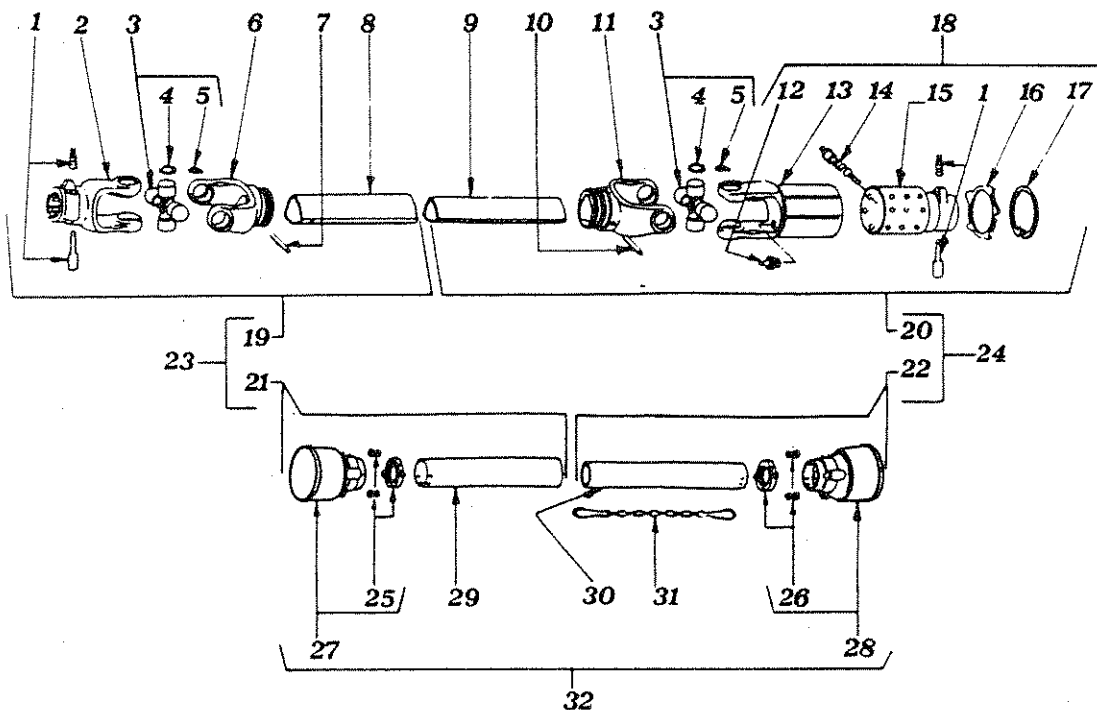

| CARDAN SHAFT 610.097 | | | |
|----------------------|---------|------|----------------------------|
| ITEM | PART NO | Q.ty | DESCRIPTION |
| 1 | 610.057 | 2 | COMPLETE PUSH BUTTON |
| 2 | 610.071 | 1 | YOKE |
| 3 | 610.070 | 2 | CROSS JOURNAL ASS. |
| 4 | 610.205 | 8 | CIRCLIP |
| 5 | 610.206 | 2 | GREASE NIPPLE |
| 6 | 610.207 | 1 | OUTER TUBE YOKE |
| 7 | 610.208 | 1 | FLEXIBLE PIN |
| 8 | 610.209 | 1 | CM. CARDAN TUBE |
| 9 | 610.210 | 1 | CM. CARDAN TUBE |
| 10 | 610.211 | 1 | FLEXIBLE PIN |
| 11 | 610.212 | 1 | INNER TUBE YOKE |
| 12 | 610.216 | 1 | GREASE NIPPLE |
| 13 | 610.217 | 1 | OUTER CASING WITH YOKE |
| 14 | 610.218 | 24 | RATCHET TOOTH |
| 15 | 610.219 | 1 | HUB |
| 16 | 610.220 | 1 | REATING WASHER |
| 17 | 610.221 | 1 | CIRCLIP |
| 18 | 610.213 | 1 | TORQUE LW3 |
| 19 | 610.341 | 1 | HALF SHAFT (WITHOUT GUARD) |
| 20 | 610.342 | 1 | HALF SHAFT (WITHOUT GUARD) |
| 21 | 610.082 | 1 | HALF SAFETY GUARD |
| 22 | 610.083 | 1 | HALF SAFETY GUARD |
| 23 | 610.426 | 1 | HALF SHAFT (WITH GUARD) |
| 24 | 610.427 | 1 | HALF SHAFT (WITH GUARD) |
| 25 | 610.078 | 1 | O. BEARING |
| 26 | 610.079 | 1 | I. BEARING |
| 27 | 610.080 | 1 | O. BASIC CONE |
| 28 | 610.081 | 1 | I. BASIC CONE |
| 29 | 610.338 | 1 | CM. SAFETY TUBE |
| 30 | 610.339 | 1 | CM. SAFETY TUBE |
| 31 | 610.068 | 1 | CHAINE |
| 32 | 610.086 | 1 | SAFETY GUARD |

CARDAN SHAFT B3 130E + LW3

PART NO. 610.096

ST/384-ST/520 PULL TYPE

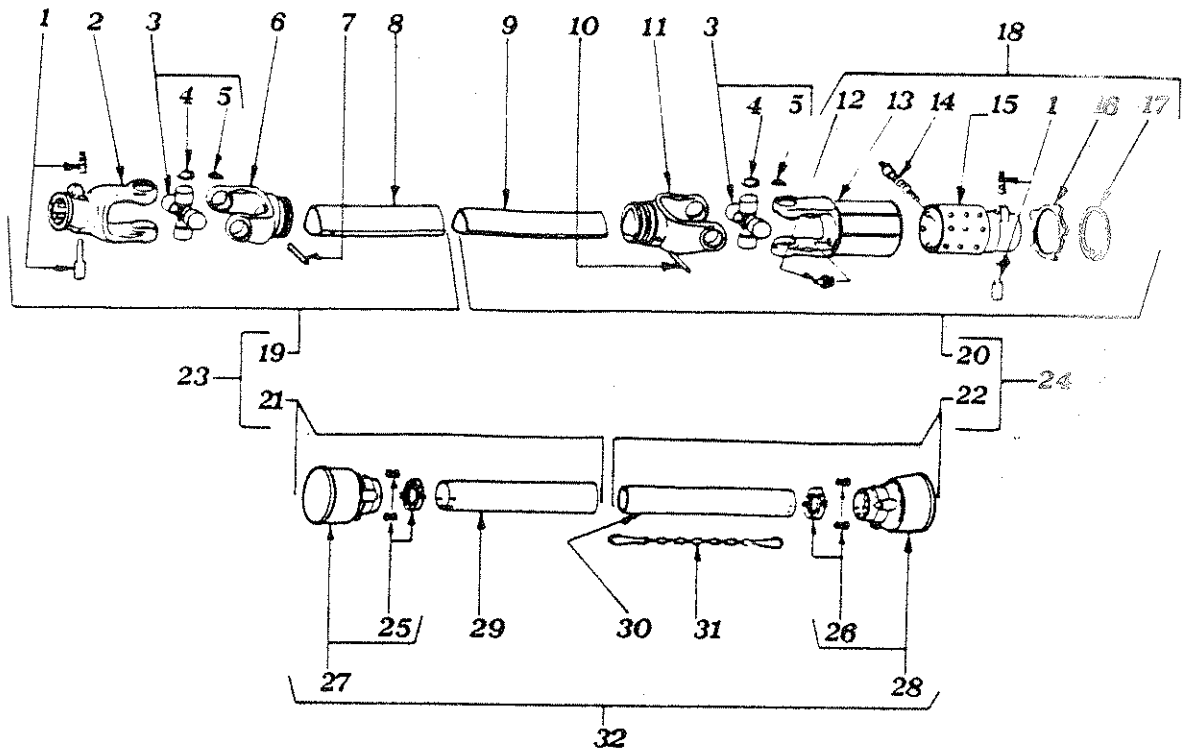

| CARDAN SHAFT 610.096 | | | |
|----------------------|---------|------|----------------------------|
| ITEM | PART NO | Q.ty | DESCRIPTION |
| 1 | 610.057 | 2 | COMPLETE PUSH BUTTON |
| 2 | 610.071 | 1 | YOKE |
| 3 | 610.070 | 2 | CROSS JOURNAL ASS. |
| 4 | 610.205 | 8 | CIRCLIP |
| 5 | 610.206 | 2 | GREASE NIPPLE |
| 6 | 610.207 | 1 | OUTER TUBE YOKE |
| 7 | 610.208 | 1 | FLEXIBLE PIN |
| 8 | 610.209 | 1 | CM. CARDAN TUBE |
| 9 | 610.210 | 1 | CM. CARDAN TUBE |
| 10 | 610.211 | 1 | FLEXIBLE PIN |
| 11 | 610.212 | 1 | INNER TUBE YOKE |
| 12 | 610.216 | 1 | GREASE NIPPLE |
| 13 | 610.217 | 1 | OUTER CASING WITH YOKE |
| 14 | 610.218 | 24 | RATCHET TOOTH |
| 15 | 610.219 | 1 | HUB |
| 16 | 610.220 | 1 | REATING WASHER |
| 17 | 610.221 | 1 | CIRCLIP |
| 18 | 610.213 | 1 | TORQUE LW3 |
| 19 | 610.222 | 1 | HALF SHAFT (WITHOUT GUARD) |
| 20 | 610.223 | 1 | HALF SHAFT (WITHOUT GUARD) |
| 21 | 610.226 | 1 | HALF SAFETY GUARD |
| 22 | 610.227 | 1 | HALF SAFETY GUARD |
| 23 | 610.224 | 1 | HALF SHAFT (WITH GUARD) |
| 24 | 610.225 | 1 | HALF SHAFT (WITH GUARD) |
| 25 | 610.078 | 1 | O. BEARING |
| 26 | 610.079 | 1 | I. BEARING |
| 27 | 610.080 | 1 | O. BASIC CONE |
| 28 | 610.081 | 1 | I. BASIC CONE |
| 29 | 610.214 | 1 | CM. SAFETY TUBE |
| 30 | 610.215 | 1 | CM. SAFETY TUBE |
| 31 | 610.068 | 1 | CHAINE |
| 32 | 610.228 | 1 | SAFETY GUARD |



AGRICULTURAL MACHINERY
sitrex[®] s.r.l.

Zona Industriale-Via L. Paciolini,22
06018 TRESTINA-(Perugia)-ITALY
Tel.(075)8540021-Telefax (075)8540523

