



# Pequea Wagon Gears

## Model WG606, 806, 1086, 1286, 1288

### Operator's Manual



**THIS MANUAL MUST BE READ AND UNDERSTOOD BEFORE ANYONE OPERATES THIS MACHINE!**

# YOU MUST FILL OUT YOUR WARRANTY REGISTRATION TO ACTIVATE YOUR WARRANTY AND TO QUALIFY FOR PARTS AND SERVICE!!

To the Owner;

Thank-You for choosing a quality product from Pequea Machine, Inc. We strive to give you the best equipment and the best level of service of any company. With a little care and maintenance this machine will do your work for you for many years. In this manual, we make an effort to get you better acquainted with the machine so you can achieve maximum performance. We design and build all of our equipment with the end user in mind so we welcome any suggestions or ideas for improvement. Please note that it is within our rights to make changes or improvements to our equipment without updating the equipment that was manufactured before the change took place.

Please take a few minutes to fill out the area below. This information will be valuable to you when ordering parts or requesting service from your dealer.

Dealer Name: \_\_\_\_\_

Dealer Phone Number: \_\_\_\_\_

Service Manager/Technician: \_\_\_\_\_

Model# and Description: \_\_\_\_\_

Serial Number: \_\_\_\_\_

Date of Purchase: \_\_\_\_\_

## TABLE OF CONTENTS

|  |   |
|--|---|
| <b>Introduction</b> .....                | 2 |
| Intended Use .....                       | 2 |
| Serial Number .....                      | 2 |
| Specifications .....                     | 2 |
| <b>Safety</b> .....                      | 3 |
| General Safety .....                     | 3 |
| Safety Decals and Reflectors .....       | 3 |
| <b>Illustrated Parts Breakdown</b> ..... | 4 |

# INTRODUCTION

## Intended Use

Pequea Wagon Gears are designed for transporting heavy loads of material on farms. They are designed to be towed by a tractor traveling under 25 mph (specific applications may require lower operating speeds). Pequea’s wagon gears are not intended to be used on public roads.

## Serial Number

The wagon gear’s serial number can be found beside the front left tire. Please use this number when requesting service, seeking information, or ordering parts. For the operator’s convenience, space to record the serial number, model number, purchase date, and dealer has been provided inside the front cover of this manual.



## Specifications



| Specifications      | 606                         | 806                               | 1086               | 1286      | 1288                |
|---------------------|-----------------------------|-----------------------------------|--------------------|-----------|---------------------|
| Capacity            | 12,000*                     | 16,000*                           | 20,000*            | 24,000*   |                     |
| Spindle             | 1 3/4"                      | 2"                                |                    |           | 2 3/4"              |
| Hubs                | 6 Bolt 888                  |                                   | 6 Bolt 783         |           | 8 Bolt              |
| Bearings            | Tapered Roller              |                                   |                    |           |                     |
| Pole Reach          | 8' x 2 5/8"                 | 8' x 2 7/8"                       |                    |           | 8' x 3 5/8"         |
| Optional            | 10', 12', 14'               |                                   |                    |           | 10', 12'            |
| Post Spacing        | 38" or 42"                  |                                   |                    |           |                     |
| Rear Hitch          | Yes                         |                                   |                    |           |                     |
| Tongue              | 92" - 128"                  |                                   |                    |           |                     |
| Optional            | 72" - 108"                  | 116" - 152"                       |                    |           |                     |
| Spring Assist       | N/A                         | Standard                          |                    |           |                     |
| Track Width         | 73"                         |                                   | 81"                |           | 85"                 |
| Wheels              | 15 x 6                      | 15 x 8                            | 15 x 10            |           |                     |
| Axles (Bolsters)    | 3 x 5 1/2 x 9G Formed Steel | 3 1/4 x 7 1/4 x 3/16 Formed Steel | 4 x 8 x 3/6 Tubing |           | 4 x 10 x 1/4 Tubing |
| Weight (Less Tires) | 515 lbs                     | 728 lbs.                          | 883 lbs            | 1090 lbs. | 1240 lbs.           |

\*Capacity is dependent upon load rating of tire used

## SAFETY

# !!SAFETY FIRST!!



*This symbol precedes specific safety instructions throughout this manual. When reading the manual, pay close attention to the information that follows this symbol.*



FAILURE TO FOLLOW INSTRUCTIONS IN THIS MANUAL COULD RESULT IN PERSONAL INJURY OR DEATH. READ ENTIRE MANUAL BEFORE OPERATING THE WAGON GEAR.



When transporting, never exceed a speed of 25 MPH (specific applications may require lower operating speeds) and avoid sudden turns.



Never allow anyone to ride on the wagon gears.



Do not transport the wagon gears on public roads.

## Safety Decals and Reflectors

*Safety decals and reflectors are for the safety of yourself and others, and must be heeded at all times. If any decals are missing, faded, or damaged in any way, please contact your dealer for replacements immediately. Shown below is the “Do not exceed 25 MPH” decal used on all models of wagon gears. Specific applications may require lower operating speeds.*



Wagon Gear Models 606, 806, 1086, 1286 & 1288

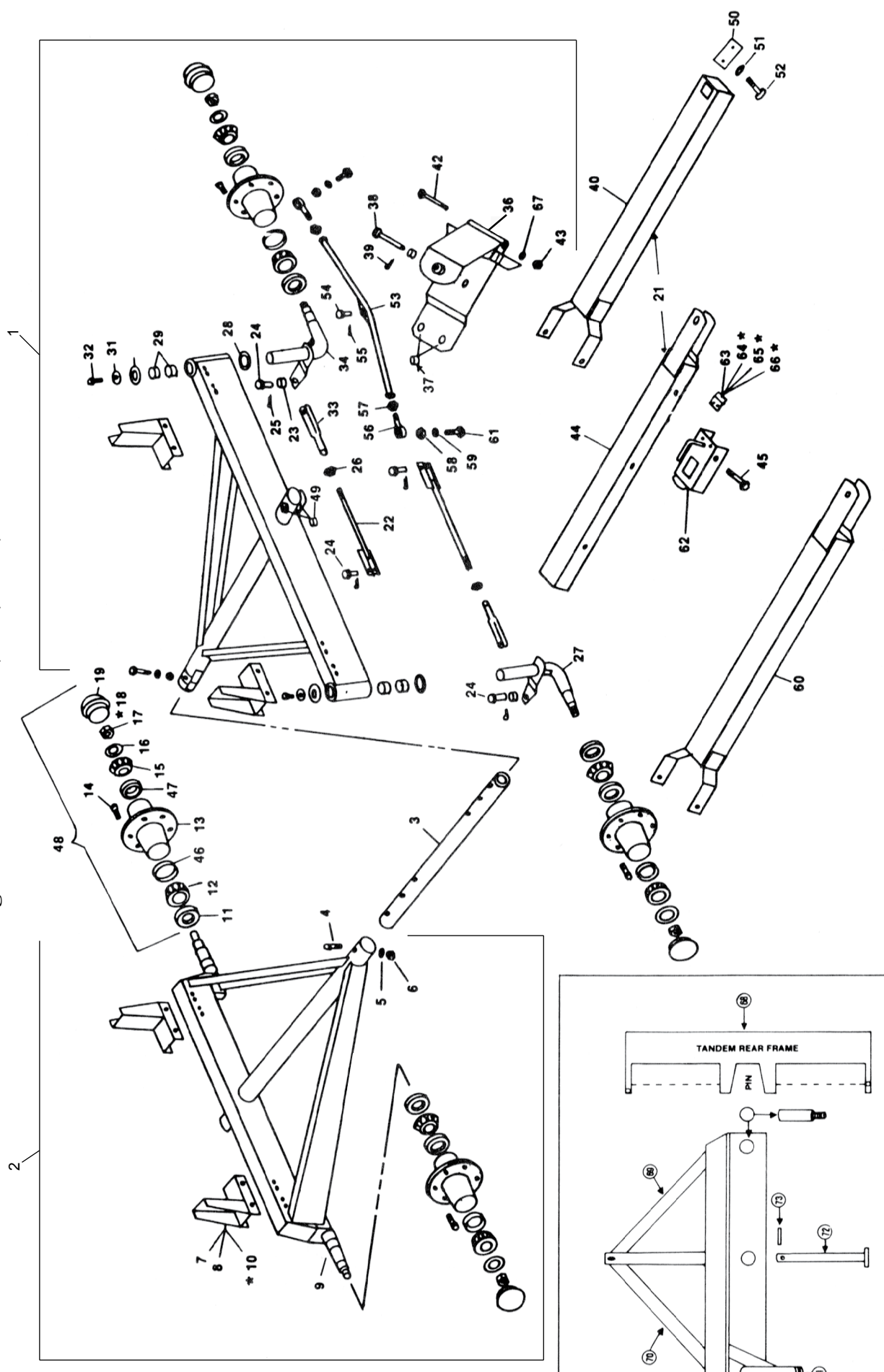

\*PARTS ARE NOT SHOWN, SEE PARTS LIST

## Wagon Gear Models 606, 806, 1086, 1286 & 1288

| <b>Ref#</b> | <b>Description</b>            | <b>606</b> | <b>806</b> | <b>1086</b> | <b>1286</b> | <b>1288</b> |
|-------------|-------------------------------|------------|------------|-------------|-------------|-------------|
| 1           | Complete Front Frame Assembly | 300000     | 300092     | 300163      | 300163      | 300226      |
| 2           | Complete Rear Frame Assembly  | 300057     | 300136     | 300186      | 300203      | 300252      |
| 3           | Reach Pole, 8'                | 300069     | 300147     | 300147      | 300147      | 300263      |
| 3A          | Reach Pole, 10'               | 300070     | 300148     | 300148      | 300148      | 300264      |
| 3B          | Reach Pole, 12'               | 300071     | 300149     | 300149      | 300149      | 300265      |
| 3C          | Reach Pole, 14'               | 300072     | 300150     | 300150      | 300150      | N/A         |
| 4           | 5/8" Bolt                     | 000630     | 000645     | 000645      | 000645      | 000655      |
| 5           | 5/8" Lock Washer              | 000860     | 000860     | 000860      | 000860      | 000860      |
| 6           | 5/8" Nut                      | 000970     | 000970     | 000970      | 000970      | 000970      |
| 7           | Bolster                       | 300073     | 300151     | 300197      | 300197      | 300197      |
| 8           | 3/8" Bolt                     | 000320     | 000325     | 000350      | 000350      | 000350      |
| 9           | Rear Spindle                  | 300067     | 300146     | 300196      | 300196      | 300262      |
| 10          | 3/8" Nut                      | 000915     | 000915     | 000915      | 000915      | 000915      |
| 11          | Grease Seal                   | 300030     | 300030     | 300174      | 300174      | 300243      |
| 12          | Inner Bearing                 | 300031     | 300031     | 300175      | 300175      | 300244      |
| 13          | Hub                           | 300033     | 300033     | 300177      | 300177      | 300246      |
| 14          | Lug Bolt                      | 300037     | 300037     | 300037      | 300037      | 300250      |
| 14A         | Lug Nut                       | N/A        | N/A        | N/A         | N/A         | 300278      |
| 15          | Outer Bearing                 | 300035     | 300035     | 300179      | 300179      | 300248      |
| 16          | Spindle Washer                | 300283     | 300283     | 300283      | 300283      | 300047      |
| 17          | Castle Nut                    | 300281     | 300281     | 300281      | 300281      | 300275      |
| 18          | Cotter Pin                    | 300282     | 300282     | 300282      | 300282      | 300132      |
| 19          | Dust Cap                      | 300036     | 300036     | 300036      | 300036      | 300249      |
| 21          | Adj. Tongue, Complete         | 300078     | 300154     | 300154      | 300154      | 300154      |
| 22          | Tie Rod                       | N/A        | 300123     | 300182      | 300182      | 300182      |
| 23          | Bronze Bushing                | N/A        | 300114     | 300114      | 300114      | 300114      |
| 24          | 3/4 x 2 Clevis Pin            | N/A        | 300130     | 300130      | 300130      | 300130      |
| 25          | Cotter Pin, 5/32 x 1-1/2      | N/A        | 001215     | 001215      | 001215      | 001215      |
| 26          | Jam Nut, 7/8                  | N/A        | 001007     | 001007      | 001007      | 001007      |
| 27          | Spindle, Right Front          | 300028     | 300121     | 300399      | 300399      | 300240      |
| 28          | Spacer                        | 500191     | 300129     | 300184      | 300184      | 300048      |
| 29          | Bronze Bushing                | 300012     | 300169     | 300169      | 300169      | 300235      |
| 30          | Spindle Housing Cover         | 300050     | 300135     | 300185      | 300185      | 300185      |
| 31          | Lock Washer, 3/8              | 000820     | 000820     | 000820      | 000820      | 000820      |
| 32          | Bolt, 3/8 x 1                 | 000270     | 000270     | 000270      | 000270      | 000270      |
| 33          | Tie Rod Clevis                | N/A        | 300330     | 300330      | 300330      | 300330      |
| 34          | Spindle, Left Front           | 300023     | 300116     | 300170      | 300170      | 300236      |
| 36          | Steering Assembly             | 300014     | 300105     | 300105      | 300105      | 300105      |

## Wagon Gear Models 606, 806, 1086, 1286 & 1288

| <b>Ref#</b> | <b>Description</b>           | <b>606</b> | <b>806</b> | <b>1086</b> | <b>1286</b> | <b>1288</b> |
|-------------|------------------------------|------------|------------|-------------|-------------|-------------|
| 37          | Bronze Bushing               | N/A        | 300114     | 300114      | 300114      | 300114      |
| 38          | Steering Head Pin            | 300051     | 300127     | 300127      | 300127      | 300127      |
| 39          | Cotter Pin, 1/8 x 1-3/4      | 300056     | 300056     | 300056      | 300056      | 300056      |
| 40          | Adj. Tongue, Rear Half       | 300081     | 300157     | 300157      | 300157      | 300157      |
| 42          | Tongue Bolt, 1"x 8"          | 000790     | 000790     | 000790      | 000790      | 000790      |
| 43          | Nut, 1"                      | 001010     | 001010     | 001010      | 001010      | 001010      |
| 44          | Adj. Tongue, Front Half      | 300079     | 300155     | 300155      | 300155      | 300155      |
| 45          | Hitch Pin                    | 300406     | 300406     | 300406      | 300406      | 300406      |
| 46          | Inner Race                   | 300032     | 300032     | 300176      | 300176      | 300245      |
| 47          | Outer Race                   | 300034     | 300034     | 300178      | 300178      | 300247      |
| 48          | Complete Hub                 | 300122     | 300122     | 300173      | 300173      | 300242      |
| 49          | Bronze Bushing               | N/A        | 500278     | 500278      | 500278      | 500278      |
| 50          | Stop Block                   | 300408     | 300408     | 300408      | 300408      | 300408      |
| 51          | Lock Washer, 5/8             | 000860     | 000860     | 000860      | 000860      | 000860      |
| 52          | Bolt, 5/8 x 1-1/2            | 000610     | 000610     | 000610      | 000610      | 000610      |
| 53          | Tie Rod                      | 300038     | N/A        | N/A         | N/A         | N/A         |
| 54          | 3/4 x 2-1/2 Clevis Pin       | 300046     | N/A        | N/A         | N/A         | N/A         |
| 55          | Cotter Pin, 5/32 x 1-1/2     | 300131     | N/A        | N/A         | N/A         | N/A         |
| 56          | Ball Joint Swivel            | 300044     | N/A        | N/A         | N/A         | N/A         |
| 57          | Jam Nut, 3/4 Fine Thread     | 300316     | N/A        | N/A         | N/A         | N/A         |
| 58          | Nut, 3/4                     | 000975     | N/A        | N/A         | N/A         | N/A         |
| 59          | Lock Washer, 3/4             | 000870     | N/A        | N/A         | N/A         | N/A         |
| 60          | Std. Tongue (non adjustable) | 300076     | N/A        | N/A         | N/A         | N/A         |
| 61          | Bolt, 3/4 x 2-3/4            | 300045     | N/A        | N/A         | N/A         | N/A         |
| 62          | Tongue Latch                 | 300401     | 300401     | 300401      | 300401      | 300401      |
| 63          | Spring Plate                 | 300405     | 300405     | 300405      | 300405      | 300405      |
| 64          | Bolt, 5/16 x 3/4             | 000210     | 000210     | 000210      | 000210      | 000210      |
| 65          | Lock Washer, 5/16            | 000810     | 000810     | 000810      | 000810      | 000810      |
| 66          | Nut, 5/16                    | 000910     | 000910     | 000910      | 000910      | 000910      |
| 67          | Lock Washer, 1"              | 000880     | 000880     | 000880      | 000880      | 000880      |
| 68          | Tandem Rear Frame            | N/A        | N/A        | N/A         | 300204      | N/A         |
| 69          | Walking Beam, Right          | N/A        | N/A        | N/A         | 302144      | N/A         |
| 70          | Walking Beam, Left           | N/A        | N/A        | N/A         | 300211      | N/A         |
| 72          | Walking Beam Pin             | N/A        | N/A        | N/A         | 300218      | N/A         |
| 73          | Bolt, 3/8 x 2-1/2            | N/A        | N/A        | N/A         | 000300      | N/A         |
| 75          | Spring Assist Kit            | 300322     | 300322     | 300322      | 300322      | 300322      |
| 76          | Extension Spring             | 200041     | 200041     | 200041      | 200041      | 200041      |
| 77          | Eye Bolt                     | 500095     | 500095     | 500095      | 500095      | 500095      |



**Notes:**



200 Jalyn Drive  
P.O. Box 399  
New Holland PA 17557

Phone: 717-354-4343  
Fax: 717-354-8843  
E-mail: [pequea@pequeamachine.com](mailto:pequea@pequeamachine.com)  
[www.pequeamachine.com](http://www.pequeamachine.com)